

Área de Desenvolvimento Econômico Oeste
 Lista de Coordenadas do Perímetro

Perímetro: 14821.823 metros
Área: 5697362.823 metros quadrados, ou 569.7363 hectares

A Área de Desenvolvimento Econômico, da Região Administrativa de Samambaia, tem seus limites definidos pelo perímetro caracterizado a partir da estação nº01 à estação nº63, descritos conforme tabela a seguir, extraídas das cartas da CODEPLAN, na escala 1:10000, KR=1.0000000:

ESTAÇÃO	N	E	D(m)	AZ
1	8244279.6092	159623.2580		
		61.825	46 49 26	
2	8244321.9127	159668.3442		
		130.778	58 37 31	
3	8244390.0000	159780.0000		
		76.736	46 50 49	
4	8244442.4834	159835.9810		
		23.184	114 28 60	
5	8244432.8751	159857.0808		
		72.364	201 28 27	
6	8244365.5346	159830.5898		
		132.400	69 50 5	
7	8244411.1767	159954.8741		
		101.471	351 42 54	
8	8244511.5892	159940.2524		
		210.187	90 0 0	
9	8244511.5892	160150.4389		
		84.641	57 22 5	
10	8244557.2313	160221.7196		
		100.566	338 1 11	
11	8244650.4875	160184.0792		
		71.019	109 38 55	
12	8244626.6073	160250.9629		
		252.546	71 27 11	
13	8244706.9373	160490.3927		
		95.177	0 45 46	
14	8244802.1061	160491.6596		
		91.053	98 13 0	
15	8244789.0930	160581.7783		
		63.151	48 2 22	
16	8244831.3171	160628.7378		
		115.849	127 55 24	
17	8244760.1155	160720.1232		
		69.040	18 3 48	
18	8244825.7530	160741.5305		
		155.507	109 54 19	
19	8244772.8082	160887.7473		
		227.483	39 34 15	
20	8244948.1607	161032.6615		
		173.811	129 4 50	
21	8244838.5877	161167.5840		
		115.338	83 30 5	
22	8244851.6414	161282.1814		
		111.104	142 41 6	
23	8244763.2783	161349.5324		
		79.420	90 43 28	
24	8244762.2742	161428.9464		
		121.432	141 0 47	
25	8244667.8864	161505.3447		
		30.245	114 2 50	
26	8244655.5620	161532.9643		
		39.208	152 12 55	
27	8244620.8741	161551.2414		
		80.349	107 10 50	
28	8244597.1402	161628.0052		
		46.692	59 26 55	
29	8244620.8741	161668.2147		

			60.319	106 15 28
30	8244603.9874	161726.1216		
			86.569	77 16 6
31	8244623.0657	161810.5618		
			79.524	69 17 43
32	8244651.1813	161884.9495		
			90.992	118 17 11
33	8244608.0623	161965.0758		
			70.479	16 34 28
34	8244675.6125	161985.1807		
			48.767	102 58 51
35	8244664.6584	162032.7011		
			68.037	174 20 19
36	8244596.9535	162039.4128		
			98.560	91 45 5
37	8244593.9411	162137.9263		
			83.087	57 52 35
38	8244638.1226	162208.2930		
			106.781	75 50 53
39	8244664.2299	162311.8329		
			46.296	62 54 16
40	8244685.3165	162353.0477		
			83.847	85 23 53
41	8244692.0437	162436.6248		
			114.495	125 46 30
42	8244625.1092	162529.5169		
			87.687	193 15 17
43	8244539.7586	162509.4121		
			73.329	124 13 9
44	8244498.5213	162570.0476		
			66.547	68 42 20
45	8244522.6885	162632.0514		
			48.258	121 20 41
46	8244497.5853	162673.2662		
			69.717	95 47 11
47	8244490.5564	162742.6279		
			136.877	154 47 27
48	8244366.7160	162800.9270		
			2210.320	182 54 26
49	8242159.2410	162688.8190		
			413.927	183 17 56
50	8241746.0000	162665.0000		
			385.032	180 44 39
51	8241361.0000	162660.0000		
			654.599	71 50 31
52	8241565.0000	163282.0000		
			390.145	140 43 15
53	8241263.0000	163529.0000		
			77.492	160 23 45
54	8241190.0000	163555.0000		
			153.052	218 22 3
55	8241070.0000	163460.0000		
			115.974	187 25 53
56	8240955.0000	163445.0000		
			113.495	247 6 24
57	8240910.8484	163340.4447		
			833.538	243 46 51
58	8240542.5851	162592.6699		
			1774.664	342 7 14
59	8242231.5415	162047.8219		
			320.543	337 19 39
60	8242527.3134	161924.2640		
			343.278	327 24 0
61	8242816.5091	161739.3166		
			327.464	317 22 9
62	8243057.4353	161517.5340		
			349.380	307 14 48
63	8243268.8965	161239.4144		
			1906.175	302 1 16
1	8244279.6092	159623.2580		

Área Rural Remanescente Veredas
Lista de Coordenadas do Perímetro

Perímetro: 5054.438 metros

Área: 1302026.078 metros quadrados, ou 130.2026 hectares

A Área Rural Remanescente Veredas, da Região Administrativa de Samambaia, tem seus limites definidos pelo perímetro caracterizado a partir da estação n.º 01 à estação n.º 04, descritos conforme tabela a seguir, extraídas das cartas da CODEPLAN, na escala 1:10000, KR=1.0000000:

ESTAÇÃO	N	E	D(m)	AZ
1	8240227.0000	164604.9998	812.294	165 22 56
2	8239441.0000	164809.9998	1772.127	251 33 17
3	8238880.2989	163128.9141	642.251	342 7 14
4	8239491.5318	162931.7338	1827.767	66 16 21
1	8240227.0000	164604.9998		

Área Rural Remanescente Taguatinga
 Lista de Coordenadas do Perímetro

Perímetro: 26062.928 metros
Área: 12215960.082 metros quadrados, ou 1221.5960 hectares

A Área Rural Remanescente Taguatinga, da Região Administrativa de Samambaia, tem seus limites definidos pelo perímetro caracterizado a partir da estação n.º 01 à estação n.º 158, descritos conforme tabela a seguir, extraídas das cartas da CODEPLAN, na escala 1:10.000, KR=1.0000000:

ESTACAO	N	E	D(m)	AZ
1	8244366.7160	162800.9270		
		133.438	76 10 25	
2	8244398.6049	162930.4988		
		36.768	123 39 39	
3	8244378.2252	162961.1023		
		175.243	159 15 37	
4	8244214.3383	163023.1595		
		83.267	114 18 42	
5	8244180.0572	163099.0421		
		28.837	45 1 55	
6	8244200.4369	163119.4445		
		33.389	7 18 49	
7	8244233.5540	163123.6949		
		24.512	123 39 39	
8	8244219.9675	163144.0973		
		52.226	156 47 8	
9	8244171.9702	163164.6833		
		44.889	108 45 31	
10	8244157.5346	163207.1882		
		50.309	158 10 36	
11	8244110.8311	163225.8904		
		56.919	178 17 18	
12	8244053.9376	163227.5906		
		36.022	250 43 48	
13	8244042.0495	163193.5867		
		31.705	187 42 16	
14	8244010.6308	163189.3362		
		33.049	133 55 36	
15	8243987.7036	163213.1389		
		37.317	59 57 32	
16	8244006.3850	163245.4426		
		37.038	36 38 15	
17	8244036.1054	163267.5452		
		28.762	71 2 57	
18	8244045.4461	163294.7482		
		25.508	143 16 44	
19	8244025.0000	163310.0000		
		109.388	142 51 24	
20	8243937.8036	163376.0497		
		83.629	100 10 29	
21	8243923.0304	163458.3635		
		33.467	143 12 4	
22	8243896.2321	163478.4104		
		104.084	97 23 22	
23	8243882.8456	163581.6303		
		109.078	132 9 16	
24	8243809.6402	163662.4937		
		53.897	113 12 2	
25	8243788.4075	163712.0317		
		62.075	79 15 43	
26	8243799.9731	163773.0195		
		75.785	129 20 15	
27	8243751.9339	163831.6339		

28	8243738.9579	163873.9864	44.296	107	2	3
			66.849	160	41	55
29	8243675.8662	163896.0826	115.860	100	33	18
30	8243654.6430	164009.9824	55.591	96	27	40
31	8243648.3875	164065.2201	64.018	145	56	6
32	8243595.3550	164101.0787	182.328	77	9	19
33	8243635.8880	164278.8446	138.117	41	17	22
34	8243739.6675	164369.9829	69.193	96	17	14
35	8243732.0899	164438.7598	67.664	136	9	23
36	8243683.2887	164485.6300	70.205	156	11	47
37	8243619.0557	164513.9650	74.388	122	34	49
38	8243578.9993	164576.6468	88.458	47	57	36
39	8243638.2356	164642.3428	116.147	131	13	49
40	8243561.6846	164729.6929	49.396	79	28	13
41	8243570.7114	164778.2572	90.746	137	50	39
42	8243503.4393	164839.1611	184.424	103	0	60
43	8243461.9011	165018.8461	116.245	131	48	58
44	8243384.3957	165105.4819	102.357	116	27	17
45	8243338.7968	165197.1208	104.794	141	38	39
46	8243256.6204	165262.1497	114.246	49	40	3
47	8243330.5632	165349.2399	60.382	32	0	21
48	8243381.7665	165381.2424	145.628	71	55	15
49	8243426.9595	165519.6801	115.631	55	46	40
50	8243491.9912	165615.2911	71.462	133	41	35
51	8243442.6259	165666.9614	98.790	161	46	21
52	8243348.7928	165697.8620	82.293	110	9	14
53	8243320.4392	165775.1161	70.791	85	39	28
54	8243325.7989	165845.7037	59.467	119	19	53
55	8243296.6685	165897.5467	119.826	67	58	58
56	8243341.5897	166008.6337	99.522	127	47	38
57	8243280.6003	166087.2783	147.843	88	28	28
58	8243284.5360	166235.0688	64.713	106	29	36
59	8243266.1635	166297.1193	68.632	69	2	53
60	8243290.7052	166361.2129	130.458	107	29	25
61	8243251.4970	166485.6399	129.404	65	4	53
62	8243306.0187	166602.9973	77.628	50	46	51
63	8243355.1019	166663.1380	48.249	90	31	58

64	8243354.6532	166711.3853		
		79.958	45	33 42
65	8243410.6350	166768.4755		
		62.745	19	44 19
66	8243469.6932	166789.6664		
		70.684	359	33 17
67	8243540.3754	166789.1170		
		185.473	27	41 35
68	8243704.6022	166875.3126		
		54.505	7	15 17
69	8243758.6706	166882.1956		
		80.387	321	49 0
70	8243821.8581	166832.5019		
		84.428	10	47 39
71	8243904.7919	166848.3135		
		270.709	41	45 13
72	8244106.7447	167028.5864		
		109.163	47	53 37
73	8244179.9392	167109.5743		
		89.814	20	36 57
74	8244264.0013	167141.1976		
		121.827	62	29 56
75	8244320.2569	167249.2579		
		97.964	19	10 55
76	8244412.7816	167281.4459		
		106.782	88	11 0
77	8244416.1667	167388.1745		
		114.733	75	21 13
78	8244445.1774	167499.1790		
		94.684	112	25 1
79	8244409.0702	167586.7078		
		138.118	38	43 21
80	8244516.8277	167673.1071		
		56.856	97	46 16
81	8244509.1399	167729.4406		
		206.726	65	50 6
82	8244593.7661	167918.0509		
		78.698	33	17 21
83	8244659.5502	167961.2454		
		88.503	102	31 3
84	8244640.3683	168047.6448		
		175.731	59	5 29
85	8244730.6363	168198.4201		
		59.227	88	10 37
86	8244732.5204	168257.6170		
		138.980	47	0 6
87	8244827.3018	168359.2633		
		60.611	117	44 12
88	8244799.0930	168412.9100		
		82.331	62	13 37
89	8244837.4569	168485.7564		
		84.099	87	9 3
90	8244841.6372	168569.7510		
		86.309	51	7 56
91	8244895.7980	168636.9505		
		83.255	104	50 38
92	8244874.4694	168717.4271		
		151.018	82	16 15
93	8244894.7797	168867.0730		
		43.768	59	49 12
94	8244916.7826	168904.9080		
		61.506	22	6 47
95	8244973.7642	168928.0608		
		123.173	83	18 39
96	8244988.1119	169050.3952		
		256.299	49	56 40
97	8245153.0480	169246.5723		
		61.581	58	31 10
98	8245185.2060	169299.0894		
		60.118	101	5 50
99	8245173.6350	169358.0830		
		92.220	26	7 5
100	8245256.4385	169398.6803		

		67.218	86 43 54
101	8245260.2707	169465.7891	
		82.368	29 15 54
102	8245332.1256	169506.0544	
		54.931	60 46 3
103	8245358.9513	169553.9892	
		61.803	29 45 40
104	8245412.6029	169584.6675	
		84.492	65 11 38
105	8245448.0513	169661.3633	
		59.137	333 0 16
106	8245500.7449	169634.5198	
		74.235	32 16 27
107	8245563.5108	169674.1592	
		92.251	42 29 34
108	8245631.5333	169736.4745	
		91.081	90 36 10
109	8245630.5753	169827.5507	
		119.509	59 7 54
110	8245691.8913	169930.1313	
		91.568	70 26 20
111	8245722.5494	170016.4141	
		37.924	106 8 3
112	8245712.0107	170052.8445	
		121.994	51 4 39
113	8245788.6558	170147.7555	
		59.191	74 36 32
114	8245804.3655	170204.8241	
		45.528	40 45 3
115	8245838.8558	170234.5437	
		50.082	84 30 41
116	8245843.6461	170284.3960	
		86.908	41 26 32
117	8245908.7945	170341.9177	
		50.632	29 29 32
118	8245952.8654	170366.8439	
		59.509	87 13 53
119	8245955.7397	170426.2831	
		40.866	50 43 45
120	8245981.6074	170457.9201	
		45.942	83 38 42
121	8245986.6927	170503.5800	
		71.722	81 33 2
122	8245997.2314	170574.5236	
		120.959	72 0 25
123	8246034.5959	170689.5672	
		549.114	166 47 44
124	8245500.0000	170815.0000	
		281.824	244 47 56
125	8245380.0000	170560.0000	
		511.004	196 29 4
126	8244890.0000	170415.0000	
		308.585	243 1 11
127	8244750.0000	170140.0000	
		640.488	257 22 27
128	8244610.0000	169515.0000	
		660.038	229 54 60
129	8244185.0000	169010.0000	
		870.244	245 12 7
130	8243820.0000	168220.0000	
		892.328	221 49 13
131	8243155.0000	167625.0000	
		314.841	212 40 50
132	8242890.0000	167455.0000	
		339.485	226 11 37
133	8242655.0000	167210.0000	
		94.868	198 26 6
134	8242565.0000	167180.0000	
		168.077	247 14 56
135	8242500.0000	167025.0000	
		60.000	180 0 0
136	8242440.0000	167025.0000	
		112.361	249 8 44

137	8242400.0000	166920.0000		
			421.900	264 33 35
138	8242360.0000	166500.0000		
			259.422	332 26 50
139	8242590.0000	166380.0000		
			270.740	274 14 11
140	8242610.0000	166110.0000		
			167.705	243 26 6
141	8242535.0000	165960.0000		
			63.246	161 33 54
142	8242475.0000	165980.0000		
			116.726	189 51 57
143	8242360.0000	165960.0000		
			300.167	240 1 6
144	8242210.0000	165700.0000		
			428.981	248 49 7
145	8242055.0000	165300.0000		
			913.250	238 39 35
146	8241580.0000	164520.0000		
			606.238	155 7 33
147	8241030.0000	164775.0000		
			343.657	188 21 57
148	8240690.0000	164725.0000		
			237.065	242 21 14
149	8240580.0000	164515.0000		
			741.485	280 5 51
150	8240710.0000	163785.0000		
			419.076	305 46 34
151	8240955.0000	163445.0000		
			115.974	7 25 53
152	8241070.0000	163460.0000		
			153.052	38 22 3
153	8241190.0000	163555.0000		
			77.492	340 23 45
154	8241263.0000	163529.0000		
			390.145	320 43 15
155	8241565.0000	163282.0000		
			654.599	251 50 31
156	8241361.0000	162660.0000		
			385.032	0 44 39
157	8241746.0000	162665.0000		
			413.927	3 17 56
158	8242159.2410	162688.8190		
			2210.320	2 54 26
1	8244366.7160	162800.9270		

Complexo Boca da Mata
Lista de Coordenadas do Perímetro

Perímetro: 4318.870 metros
Área: 430880.208 metros quadrados, ou 43.0880 hectares

A Área do Complexo Boca da Mata, da Região Administrativa de Samambaia, tem seus limites definidos pelo perímetro caracterizado a partir da estação n.º 01 à estação n.º 23, descritos conforme tabela a seguir, extraídas das cartas da CODEPLAN, na escala 1:10000, KR=1.0000000:

ESTAÇÃO	N	E	D(m)	AZ
1	8243160.0000	173080.0000		
		583.151	234 13 47	
2	8242819.1270	172606.8498		
		110.183	296 56 14	
3	8242869.0412	172508.6216		
		43.610	319 33 25	
4	8242902.2303	172480.3323		
		23.068	335 39 32	
5	8242923.2479	172470.8243		
		35.985	299 43 58	
6	8242941.0950	172439.5765		
		334.266	26 56 33	
7	8243239.0808	172591.0310		
		104.387	21 4 14	
8	8243336.4886	172628.5601		
		81.826	2 6 48	
9	8243418.2587	172631.5774		
		94.939	348 8 17	
10	8243511.1708	172612.0624		
		73.481	329 8 36	
11	8243574.2508	172574.3746		
		233.854	319 52 4	
12	8243753.0463	172423.6428		
		135.595	49 31 23	
13	8243841.0665	172526.7857		
		738.497	49 53 30	
14	8244316.8317	173091.6091		
		218.649	137 35 52	
15	8244155.3753	173239.0508		
		89.452	230 34 17	
16	8244098.5630	173169.9570		
		176.340	228 30 51	
17	8243981.7490	173037.8570		
		138.260	227 24 31	
18	8243888.1790	172936.0700		
		289.026	227 44 41	
19	8243693.8280	172722.1450		
		54.353	216 15 27	
20	8243650.0000	172690.0000		
		61.033	235 0 29	
21	8243615.0000	172640.0000		
		325.576	132 30 38	
22	8243395.0000	172880.0000		
		60.208	228 21 59	
23	8243355.0000	172835.0000		
		313.129	128 31 1	
1	8243160.0000	173080.0000		

Complexo de Furnas
Lista de Coordenadas do Perímetro

Perímetro: 5877.342 metros
Área: 1538717.016 metros quadrados, ou 153.8717 hectares

A Área do Complexo de Furnas, da Região Administrativa de Samambaia, tem seus limites definidos pelo perímetro caracterizado a partir da estação n.º 01 à estação n.º 43, descritos conforme tabela a seguir, extraídas das cartas da CODEPLAN, na escala 1:10000, KR=1.0000000:

ESTAÇÃO	N	E	D(m)	AZ
1	8243766.1678	172412.5808	196.877	244 19 20
2	8243680.8590	172235.1460	12.141	262 24 47
3	8243679.2560	172223.1110	58.035	244 13 25
4	8243654.0190	172170.8510	229.313	242 41 26
5	8243548.8110	171967.0970	48.489	241 9 22
6	8243525.4190	171924.6240	165.129	242 49 56
7	8243450.0210	171777.7130	51.291	247 1 20
8	8243429.9984	171730.4921	27.692	243 57 16
9	8243417.8390	171705.6120	73.136	241 48 11
10	8243383.2820	171641.1550	59.931	243 44 36
11	8243356.7690	171587.4079	116.568	244 32 34
12	8243306.6640	171482.1580	73.880	245 11 5
13	8243275.6567	171415.0993	37.583	246 16 57
14	8243260.5400	171380.6910	16.255	248 57 0
15	8243254.7015	171365.5207	46.102	251 6 3
16	8243239.7689	171321.9042	123.267	334 10 27
17	8243350.7240	171268.2050	388.078	334 13 9
18	8243700.1740	171099.4180	224.703	334 47 14
19	8243903.4700	171003.6990	100.039	333 34 27
20	8243993.0557	170959.1777	144.932	333 34 27
21	8244122.8438	170894.6771	196.091	65 4 59
22	8244205.4575	171072.5156	95.823	73 12 53
23	8244233.1299	171164.2556	173.083	82 1 33
24	8244257.1415	171335.6653	62.462	352 1 33
25	8244319.0000	171327.0000	106.442	19 28 2
26	8244419.3565	171362.4737	135.193	355 43 55

27	8244554.1747	171352.4121		
			227.296	75 27 29
28	8244611.2466	171572.4265		
			86.961	144 51 26
29	8244540.1371	171622.4826		
			87.191	136 32 57
30	8244476.8396	171682.4464		
			87.191	128 13 49
31	8244422.8838	171750.9373		
			87.191	119 54 41
32	8244379.4051	171826.5139		
			87.191	111 35 34
33	8244347.3184	171907.5860		
			87.191	103 16 26
34	8244327.2990	171992.4473		
			87.191	94 57 18
35	8244319.7682	172079.3123		
			87.191	86 38 10
36	8244324.8844	172166.3528		
			87.191	78 19 2
37	8244342.5400	172251.7373		
			87.191	69 59 54
38	8244372.3634	172333.6689		
			541.982	65 50 20
39	8244594.1987	172828.1721		
			202.258	135 28 30
40	8244450.0000	172970.0000		
			180.340	137 35 52
41	8244316.8317	173091.6091		
			738.497	229 53 30
42	8243841.0665	172526.7857		
			135.595	229 31 23
43	8243753.0463	172423.6428		
			17.162	319 52 4
1	8243766.1678	172412.5808		

Malha Urbana Existente
Lista de Coordenadas do Perímetro

Perímetro: 35212.558 metros
Área: 26020808.725 metros quadrados, ou 2602.0809 hectares

A área da Malha Urbana Existente, da Região Administrativa de Samambaia, tem seus limites definidos pelo perímetro caracterizado a partir da estação nº01 à estação nº83, descritos conforme tabela a seguir, extraídas das cartas da CODEPLAN, na escala 1:10000, KR=1.0000000:

ESTAÇÃO	N	E	D(m)	AZ
1	8238743.8187	163172.9419		
		143.406	342 7 14	
2	8238880.2989	163128.9141		
		1772.127	71 33 17	
3	8239441.0000	164809.9998		
		812.294	345 22 56	
4	8240227.0000	164604.9998		
		1827.767	246 16 21	
5	8239491.5318	162931.7338		
		1104.390	342 7 14	
6	8240542.5851	162592.6699		
		833.538	63 46 51	
7	8240910.8484	163340.4447		
		113.495	67 6 24	
8	8240955.0000	163445.0000		
		419.076	125 46 34	
9	8240710.0000	163785.0000		
		741.485	100 5 51	
10	8240580.0000	164515.0000		
		237.065	62 21 14	
11	8240690.0000	164725.0000		
		343.657	8 21 57	
12	8241030.0000	164775.0000		
		606.238	335 7 33	
13	8241580.0000	164520.0000		
		913.250	58 39 35	
14	8242055.0000	165300.0000		
		428.981	68 49 7	
15	8242210.0000	165700.0000		
		300.167	60 1 6	
16	8242360.0000	165960.0000		
		116.726	9 51 57	
17	8242475.0000	165980.0000		
		63.246	341 33 54	
18	8242535.0000	165960.0000		
		167.705	63 26 6	
19	8242610.0000	166110.0000		
		270.740	94 14 11	
20	8242590.0000	166380.0000		
		259.422	152 26 50	
21	8242360.0000	166500.0000		
		421.900	84 33 35	
22	8242400.0000	166920.0000		
		112.361	69 8 44	
23	8242440.0000	167025.0000		
		60.000	0 0 0	
24	8242500.0000	167025.0000		
		168.077	67 14 56	
25	8242565.0000	167180.0000		
		94.868	18 26 6	
26	8242655.0000	167210.0000		
		339.485	46 11 37	
27	8242890.0000	167455.0000		
		314.841	32 40 50	
28	8243155.0000	167625.0000		
		892.328	41 49 13	

29	8243820.0000	168220.0000		
			870.244	65 12 7
30	8244185.0000	169010.0000		
			660.038	49 54 60
31	8244610.0000	169515.0000		
			640.488	77 22 27
32	8244750.0000	170140.0000		
			308.585	63 1 11
33	8244890.0000	170415.0000		
			511.004	16 29 4
34	8245380.0000	170560.0000		
			281.824	64 47 56
35	8245500.0000	170815.0000		
			172.047	125 32 16
36	8245400.0000	170955.0000		
			305.287	148 23 33
37	8245140.0000	171115.0000		
			130.245	82 4 30
38	8245157.9577	171244.0015		
			637.774	149 0 20
39	8244611.2466	171572.4265		
			227.296	255 27 29
40	8244554.1747	171352.4121		
			135.193	175 43 55
41	8244419.3565	171362.4737		
			106.442	199 28 2
42	8244319.0000	171327.0000		
			62.462	172 1 33
43	8244257.1415	171335.6653		
			173.083	262 1 33
44	8244233.1299	171164.2556		
			95.823	253 12 53
45	8244205.4575	171072.5156		
			196.091	245 4 59
46	8244122.8438	170894.6771		
			144.932	153 34 27
47	8243993.0557	170959.1777		
			100.039	153 34 27
48	8243903.4700	171003.6990		
			224.703	154 47 14
49	8243700.1740	171099.4180		
			388.078	154 13 9
50	8243350.7240	171268.2050		
			123.267	154 10 27
51	8243239.7689	171321.9042		
			46.102	71 6 3
52	8243254.7015	171365.5207		
			16.255	68 57 0
53	8243260.5400	171380.6910		
			37.583	66 16 57
54	8243275.6567	171415.0993		
			73.880	65 11 5
55	8243306.6640	171482.1580		
			116.568	64 32 34
56	8243356.7690	171587.4079		
			59.931	63 44 36
57	8243383.2820	171641.1550		
			73.136	61 48 11
58	8243417.8390	171705.6120		
			27.692	63 57 16
59	8243429.9984	171730.4921		
			51.291	67 1 20
60	8243450.0210	171777.7130		
			165.129	62 49 56
61	8243525.4190	171924.6240		
			48.489	61 9 22
62	8243548.8110	171967.0970		
			229.313	62 41 26
63	8243654.0190	172170.8510		
			58.035	64 13 25
64	8243679.2560	172223.1110		
			12.141	82 24 47
65	8243680.8590	172235.1460		
			196.877	64 19 20

66	8243766.1678	172412.5808	251.017	139 52 4
67	8243574.2508	172574.3746	73.481	149 8 36
68	8243511.1708	172612.0624	94.939	168 8 17
69	8243418.2587	172631.5774	81.826	182 6 48
70	8243336.4886	172628.5601	104.387	201 4 14
71	8243239.0808	172591.0310	334.266	206 56 33
72	8242941.0950	172439.5765	35.985	119 43 58
73	8242923.2479	172470.8243	23.068	155 39 32
74	8242902.2303	172480.3323	43.610	139 33 25
75	8242869.0412	172508.6216	110.183	116 56 14
76	8242819.1270	172606.8498	583.151	54 13 47
77	8243160.0000	173080.0000	802.698	143 48 24
78	8242512.1980	173554.0015	1069.682	234 32 44
79	8241891.7220	172682.6636	972.924	252 18 38
80	8241596.0906	171755.7426	263.410	246 44 8
81	8241492.0500	171513.7500	1344.315	251 32 46
82	8241066.5165	170238.5619	1511.122	251 59 22
83	8240599.2903	168801.4849	5926.489	251 45 18
1	8238743.8187	163172.9419		

Parque Três Meninas
Lista de Coordenadas do Perímetro

Perímetro: 3124.419 metros
Área: 529069.836 metros quadrados, ou 52.9070 hectares

A Área do Parque Três Meninas, da Região Administrativa de Samambaia, tem seus limites definidos pelo perímetro caracterizado a partir da estação n.º 01 à estação n.º 19, descritos conforme tabela a seguir, extraídas das cartas da CODEPLAN, na escala 1:10000, KR=1.0000000:

ESTAÇÃO	N	E	D(m)	AZ
1	8242520.4868	166936.9849		
		303.540	69 4 14	
2	8242628.9167	167220.4974		
		55.057	319 14 53	
3	8242670.6245	167184.5573		
		249.124	333 19 52	
4	8242893.2448	167072.7417		
		292.568	330 36 45	
5	8243148.1649	166929.1742		
		298.213	330 37 26	
6	8243408.0331	166782.8879		
		14.645	280 14 1	
7	8243410.6350	166768.4755		
		79.958	225 33 42	
8	8243354.6532	166711.3853		
		48.249	270 31 58	
9	8243355.1019	166663.1380		
		77.628	230 46 51	
10	8243306.0187	166602.9973		
		129.404	245 4 53	
11	8243251.4970	166485.6399		
		130.458	287 29 25	
12	8243290.7052	166361.2129		
		68.632	249 2 53	
13	8243266.1635	166297.1193		
		21.511	220 17 46	
14	8243249.7567	166283.2073		
		178.569	183 44 54	
15	8243071.5700	166271.5332		
		260.991	184 3 22	
16	8242811.2332	166253.0721		
		272.923	144 37 48	
17	8242588.6826	166411.0545		
		296.507	83 45 35	
18	8242620.9125	166705.8047		
		151.198	62 46 29	
19	8242690.0845	166840.2525		
		195.245	150 18 4	
1	8242520.4868	166936.9849		

Parque Boca da Mata
Lista de Coordenadas do Perímetro

Perímetro: 5651.660 metros
Área: 1790426.916 metros quadrados, ou 179.0427 hectares

A Área do Parque Boca da Mata, da Região Administrativa de Samambaia, tem seus limites definidos pelo perímetro caracterizado a partir da estação n.º 01 à estação n.º 34, descritos conforme tabela a seguir, extraídas das cartas da CODEPLAN, na escala 1:10000, KR=1.0000000:

ESTAÇÃO	N	E	D(m)	AZ
1	8242512.1980	173554.0015		
			802.698	323 48 24
2	8243160.0000	173080.0000		
			313.129	308 31 1
3	8243355.0000	172835.0000		
			60.208	48 21 59
4	8243395.0000	172880.0000		
			325.576	312 30 38
5	8243615.0000	172640.0000		
			61.033	55 0 29
6	8243650.0000	172690.0000		
			54.353	36 15 27
7	8243693.8280	172722.1450		
			289.026	47 44 41
8	8243888.1790	172936.0700		
			138.260	47 24 31
9	8243981.7490	173037.8570		
			176.340	48 30 51
10	8244098.5630	173169.9570		
			89.452	50 34 17
11	8244155.3753	173239.0508		
			113.217	61 59 46
12	8244208.5343	173339.0116		
			78.658	65 32 51
13	8244241.0942	173410.6147		
			52.769	70 7 25
14	8244259.0353	173460.2405		
			23.673	134 1 13
15	8244242.5843	173477.2639		
			87.659	126 16 42
16	8244190.7157	173547.9304		
			23.353	135 2 50
17	8244174.1890	173564.4299		
			56.999	154 55 40
18	8244122.5603	173588.5839		
			12.483	120 40 60
19	8244116.1905	173599.3190		
			55.969	143 18 27
20	8244071.3118	173632.7614		
			44.895	123 26 58
21	8244046.5658	173670.2203		
			28.580	148 54 15
22	8244022.0924	173684.9811		
			30.492	156 14 15
23	8243994.1854	173697.2677		
			85.560	134 45 21
24	8243933.9437	173758.0248		
			29.355	139 12 50
25	8243911.7174	173777.2007		
			18.436	121 12 54
26	8243902.1628	173792.9679		
			56.468	139 34 42
27	8243859.1738	173829.5825		
			27.781	128 25 15
28	8243841.9096	173851.3482		

			89.752	81	4	55
29	8243855.8230	173940.0150				
			312.264	91	39	53
30	8243846.7510	174252.1470				
			89.731	61	34	45
31	8243889.4580	174331.0630				
			650.444	152	28	30
32	8243312.6376	174631.6552				
			1255.568	234	37	60
33	8242585.9054	173607.7839				
			28.913	140	34	50
34	8242563.5698	173626.1432				
			88.563	234	32	44
1	8242512.1980	173554.0015				

Zona Rural de Uso Diversificado
Lista de Coordenadas do Perímetro

Perímetro: 43457.967 metros
Área: 53928234.312 metros quadrados, ou 5392.8234 hectares

A Área da Zona Rural de Uso Diversificado, da Região Administrativa de Samambaia, tem seus limites definidos pelo perímetro caracterizado a partir da estação n.º 01 à estação n.º 424, descritos conforme tabela a seguir, extraídas das cartas da CODEPLAN, na escala 1:10000, KR=1.0000000:

ESTAÇÃO	N	E	D(m)	AZ
1	8236202.7992	150932.9885		
		81.671	15 45 55	
2	8236281.3980	150955.1782		
		91.791	340 45 9	
3	8236368.0580	150924.9195		
		49.450	60 56 26	
4	8236392.0766	150968.1445		
		142.475	1 37 22	
5	8236534.4948	150972.1790		
		99.052	9 46 43	
6	8236632.1079	150989.0022		
		27.967	35 14 35	
7	8236654.9485	151005.1402		
		24.638	11 0 49	
8	8236679.1328	151009.8471		
		19.726	324 15 59	
9	8236695.1452	150998.3268		
		52.210	262 36 26	
10	8236688.4274	150946.5509		
		25.772	277 29 19	
11	8236691.7862	150920.9991		
		28.723	10 47 40	
12	8236720.0012	150926.3785		
		29.771	64 36 47	
13	8236732.7651	150953.2750		
		86.846	27 10 54	
14	8236810.0202	150992.9476		
		55.924	16 3 15	
15	8236863.7629	151008.4130		
		52.283	322 48 35	
16	8236905.4135	150976.8096		
		45.707	305 48 46	
17	8236932.1582	150939.7445		
		45.055	357 26 2	
18	8236977.1678	150937.7273		
		29.590	291 17 59	
19	8236987.9164	150910.1582		
		27.580	316 56 53	
20	8237008.0698	150891.3306		
		99.757	12 27 23	
21	8237105.4785	150912.8480		
		68.545	30 48 40	
22	8237164.3488	150947.9572		
		54.562	67 33 43	
23	8237185.1741	150998.3884		
		114.831	24 56 10	
24	8237289.3006	151046.8021		
		60.061	11 42 1	
25	8237348.1141	151058.9820		
		54.990	327 27 3	
26	8237394.4672	151029.3958		
		25.563	356 59 3	
27	8237419.9950	151028.0509		

			54.857	53 59 54
28	8237452.2406	151072.4304		
			120.104	92 7 57
29	8237447.7717	151192.4512		
			59.375	59 23 37
30	8237478.0019	151243.5547		
			58.670	336 21 3
31	8237531.7446	151220.0203		
			41.832	43 43 29
32	8237561.9749	151248.9341		
			66.210	119 8 41
33	8237529.7292	151306.7617		
			156.710	82 26 37
34	8237550.3371	151462.1103		
			51.334	43 57 58
35	8237587.2851	151497.7483		
			49.409	337 36 3
36	8237632.9664	151478.9206		
			45.633	316 10 0
37	8237665.8839	151447.3172		
			91.911	258 37 6
38	8237647.7457	151357.2136		
			65.747	352 21 35
39	8237712.9087	151348.4723		
			67.949	22 6 18
40	8237775.8632	151374.0418		
			49.952	118 57 25
41	8237751.6790	151417.7489		
			35.180	43 28 43
42	8237777.2068	151441.9557		
			128.507	324 7 24
43	8237881.3333	151366.6453		
			44.465	355 39 49
44	8237925.6710	151363.2832		
			41.827	32 5 5
45	8237961.1099	151385.5007		
			41.262	322 55 3
46	8237994.0273	151360.6213		
			45.778	299 55 49
47	8238016.8680	151320.9488		
			42.313	327 17 42
48	8238052.4725	151298.0867		
			65.126	46 16 53
49	8238097.4820	151345.1557		
			82.958	14 42 33
50	8238177.7213	151366.2198		
			44.461	86 32 6
51	8238180.4084	151410.5991		
			105.079	43 12 46
52	8238256.9918	151482.5475		
			30.218	110 50 12
53	8238246.2432	151510.7889		
			67.674	155 57 35
54	8238184.4391	151538.3580		
			123.938	44 7 14
55	8238273.4116	151624.6402		
			39.966	332 58 56
56	8238309.0160	151606.4849		
			31.869	341 32 56
57	8238339.2463	151596.3987		
			34.556	26 35 12
58	8238370.1484	151611.8643		
			154.060	51 55 20
59	8238465.1619	151733.1358		
			51.202	113 10 45
60	8238445.0084	151780.2048		
			58.882	38 4 23
61	8238491.3615	151816.5152		
			122.885	96 15 59
62	8238477.9486	151938.6656		
			36.858	75 12 60
63	8238487.3535	151974.3035		
			48.821	67 20 19

64	8238506.1635	152019.3553		
		17.024	99	4 55
65	8238503.4764	152036.1656		
		58.001	161	45 32
66	8238448.3901	152054.3208		
		59.408	134	30 53
67	8238406.7395	152096.6830		
		26.111	78	7 20
68	8238412.1138	152122.2347		
		78.835	17	22 10
69	8238487.3535	152145.7693		
		23.829	73	37 30
70	8238494.0714	152168.6314		
		63.305	142	44 21
71	8238443.6876	152206.9591		
		24.474	74	4 7
72	8238450.4055	152230.4935		
		117.961	358	45 19
73	8238568.3391	152227.9308		
		90.084	337	37 27
74	8238651.6403	152193.6376		
		24.417	352	5 9
75	8238675.8246	152190.2757		
		23.019	96	42 14
76	8238673.1374	152213.1377		
		65.592	134	8 34
77	8238627.4561	152260.2068		
		72.629	53	18 24
78	8238670.8543	152318.4438		
		168.431	64	59 24
79	8238742.0634	152471.0820		
		119.963	38	53 12
80	8238835.4414	152546.3925		
		53.357	46	37 45
81	8238872.0827	152585.1791		
		132.473	58	30 42
82	8238941.2764	152698.1449		
		78.932	98	48 44
83	8238929.1843	152776.1450		
		40.618	83	21 6
84	8238933.8868	152816.4898		
		87.559	53	59 45
85	8238985.3577	152887.3225		
		123.099	29	48 25
86	8239092.1713	152948.5122		
		53.761	323	6 16
87	8239135.1655	152916.2363		
		41.469	332	59 53
88	8239172.1136	152897.4087		
		23.519	59	3 36
89	8239184.2057	152917.5811		
		131.674	130	0 14
90	8239099.5609	153018.4433		
		47.027	107	33 29
91	8239085.3741	153063.2798		
		53.648	127	50 56
92	8239052.4567	153105.6420		
		46.196	68	40 53
93	8239069.2513	153148.6765		
		126.558	87	15 42
94	8239075.2973	153275.0905		
		24.667	72	34 5
95	8239082.6870	153298.6250		
		63.689	44	10 19
96	8239128.3682	153343.0044		
		54.402	62	58 42
97	8239153.0846	153391.4677		
		25.085	20	23 38
98	8239176.5971	153400.2091		
		22.585	337	13 47
99	8239197.4223	153391.4677		
		112.492	310	36 43
100	8239270.6468	153306.0710		

			61.307	332 34 14
101	8239325.0613	153277.8297		
			42.755	0 50 53
102	8239367.8119	153278.4626		
			52.820	36 44 60
103	8239410.1343	153310.0661		
			61.888	21 0 39
104	8239467.9077	153332.2557		
			29.744	341 32 57
105	8239496.1226	153322.8420		
			83.339	303 47 36
106	8239542.4757	153253.5832		
			21.213	10 57 51
107	8239563.3011	153257.6177		
			36.771	78 7 59
108	8239570.8626	153293.6027		
			54.562	112 26 17
109	8239550.0373	153344.0338		
			62.259	134 32 9
110	8239506.3714	153388.4131		
			32.263	144 17 53
111	8239480.1717	153407.2408		
			20.323	55 48 33
112	8239491.5921	153424.0512		
			54.945	12 0 28
113	8239545.3348	153435.4821		
			45.048	17 22 10
114	8239588.3289	153448.9305		
			25.878	71 32 47
115	8239596.5202	153473.4779		
			141.652	169 10 2
116	8239457.3922	153500.1008		
			20.868	185 26 42
117	8239436.6188	153498.1207		
			46.537	240 43 54
118	8239413.8670	153457.5249		
			17.835	160 32 36
119	8239397.0504	153463.4657		
			37.130	90 0 0
120	8239397.0504	153500.5959		
			53.871	118 38 57
121	8239371.2224	153547.8712		
			42.160	35 57 15
122	8239405.3501	153572.6248		
			48.383	59 15 39
123	8239430.0803	153614.2105		
				63.4
				38
				87
				19
				7
124	8239433.0480	153677.5795		
			96.906	104 11 50
125	8239409.2808	153771.5258		
			47.125	86 23 22
126	8239412.2484	153818.5573		
			33.185	153 24 49
127	8239382.5721	153833.4093		
			67.448	184 12 33
128	8239315.3058	153828.4587		
			23.354	143 35 24
129	8239296.5108	153842.3206		
			24.452	68 38 51
130	8239305.4137	153865.0938		
			121.583	30 52 3
131	8239409.7754	153927.4726		
			30.492	54 16 18
132	8239427.5811	153952.2260		
			66.694	114 4 19
133	8239400.3779	154013.1195		
			15.836	194 28 59
134	8239385.0451	154009.1590		

			51.139	244	12	0
135	8239362.7879	153963.1176				
			31.570	212	13	12
136	8239336.0792	153946.2852				
			26.427	146	16	51
137	8239314.0981	153960.9554				
			225.588	94	54	19
138	8239294.8085	154185.7169				
			67.644	48	17	20
139	8239339.8175	154236.2140				
			29.495	9	52	48
140	8239368.8750	154241.2749				
			58.111	290	25	27
141	8239389.1538	154186.8174				
			67.578	312	53	45
142	8239435.1520	154137.3103				
			24.281	3	30	25
143	8239459.3876	154138.7956				
			56.810	77	25	43
144	8239471.7527	154194.2434				
			67.686	87	29	17
145	8239474.7192	154261.8641				
			41.574	141	44	24
146	8239442.0753	154287.6077				
			65.480	47	10	14
147	8239486.5897	154335.6294				
			63.616	69	2	40
148	8239509.3415	154395.0377				
			34.793	150	7	51
149	8239479.1706	154412.3652				
			99.887	187	58	37
150	8239380.2497	154398.5032				
			122.071	89	50	35
151	8239380.5843	154520.5734				
			70.651	106	15	42
152	8239360.8001	154588.3979				
			52.205	9	49	42
153	8239412.2390	154597.3092				
			18.945	40	47	25
154	8239426.5825	154609.6859				
			35.429	105	22	54
155	8239417.1851	154643.8458				
			70.840	153	45	28
156	8239353.6464	154675.1688				
			45.390	200	25	39
157	8239311.1104	154659.3265				
			72.223	245	44	19
158	8239281.4340	154593.4822				
			29.654	207	52	11
159	8239255.2199	154579.6203				
			26.630	144	48	30
160	8239233.4573	154594.9674				
			94.409	80	20	56
161	8239249.2847	154688.0405				
			51.696	59	31	49
162	8239275.4987	154732.5968				
			74.554	34	11	53
163	8239337.1618	154774.5001				
			54.941	321	33	21
164	8239380.1924	154740.3403				
			15.405	354	28	2
165	8239395.5252	154738.8551				
			17.623	51	52	8
166	8239406.4065	154752.7170				
			87.313	105	26	27
167	8239383.1601	154836.8788				
			110.780	21	46	21
168	8239486.0379	154877.9695				
			31.578	76	24	42
169	8239493.4570	154908.6638				
			33.249	143	26	44
170	8239466.7483	154928.4666				
			40.418	201	33	34

171	8239429.1583	154913.6145		
		23.036	165	3 18
172	8239406.9011	154919.5554		
		107.548	113	52 19
173	8239363.3771	155017.9033		
		26.631	48	2 22
174	8239381.1828	155037.7060		
		66.743	11	59 13
175	8239446.4706	155051.5679		
		58.339	331	35 57
176	8239497.7877	155023.8200		
		35.010	23	19 28
177	8239529.9370	155037.6820		
		73.606	57	56 14
178	8239569.0107	155100.0608		
		76.977	357	58 20
179	8239645.9397	155097.3371		
		52.001	25	22 1
180	8239692.9272	155119.6152		
		17.929	39	25 37
181	8239706.7761	155131.0017		
		26.054	104	17 15
182	8239700.3462	155156.2503		
		113.402	142	57 15
183	8239609.8336	155224.5699		
		20.684	68	58 49
184	8239617.2527	155243.8775		
		96.543	21	59 1
185	8239706.7761	155280.0176		
		62.033	0	34 21
186	8239768.8060	155280.6374		
		93.987	66	25 30
187	8239806.3959	155366.7796		
		31.440	117	3 18
188	8239792.0954	155394.7793		
		56.542	60	5 30
189	8239820.2879	155443.7913		
		212.963	93	19 49
190	8239807.9168	155656.3950		
		43.367	154	17 28
191	8239768.8430	155675.2075		
		62.569	53	28 28
192	8239806.0829	155725.4876		
		74.738	107	35 40
193	8239783.4912	155796.7298		
		48.382	78	53 50
194	8239792.8082	155844.2067		
		56.631	44	7 3
195	8239833.4645	155883.6296		
		37.047	349	27 4
196	8239869.8858	155876.8471		
		47.307	357	3 60
197	8239917.1308	155874.4261		
		59.931	43	52 52
198	8239960.3281	155915.9684		
		45.616	15	4 55
199	8240004.3724	155927.8376		
		21.316	72	39 41
200	8240010.7249	155948.1849		
		134.631	118	1 29
201	8239947.4686	156067.0296		
		33.067	90	44 2
202	8239947.0451	156100.0938		
		18.957	100	17 44
203	8239943.6570	156118.7454		
		18.807	172	13 39
204	8239925.0229	156121.2888		
		49.486	241	55 16
205	8239901.7303	156077.6270		
		21.051	229	55 32
206	8239888.1782	156061.5188		
		30.688	153	46 2
207	8239860.6505	156075.0836		

			30.311	110 26 40
208	8239850.0630	156103.4850		
			38.303	62 54 51
209	8239867.5032	156137.5869		
			81.713	38 30 2
210	8239931.4522	156188.4550		
			56.207	3 55 8
211	8239987.5273	156192.2965		
			29.318	37 23 33
212	8240010.8200	156210.1002		
			105.132	93 49 2
213	8240003.8209	156314.9992		
			42.548	45 50 2
214	8240033.4660	156345.5201		
			102.946	25 53 9
215	8240126.0832	156390.4643		
			56.899	351 51 45
216	8240182.4091	156382.4102		
			54.291	327 24 5
217	8240228.1473	156353.1609		
			54.507	338 6 11
218	8240278.7221	156332.8331		
			36.484	9 21 42
219	8240314.7198	156338.7677		
			26.736	92 43 25
220	8240313.4494	156365.4734		
			127.148	122 40 13
221	8240244.8143	156472.5051		
			28.696	148 52 2
222	8240220.2511	156487.3417		
			18.207	77 54 58
223	8240224.0627	156505.1455		
			78.475	38 0 34
224	8240285.8941	156553.4701		
			49.930	21 32 31
225	8240332.3361	156571.8034		
			33.821	52 9 4
226	8240353.0878	156598.5092		
			60.407	337 43 55
227	8240408.9901	156575.6185		
			43.434	357 46 48
228	8240452.3919	156573.9361		
			29.457	40 21 35
229	8240474.8376	156593.0117		
			40.873	95 21 3
230	8240471.0261	156633.7061		
			47.809	79 47 44
231	8240479.4961	156680.7589		
			47.735	93 2 34
232	8240476.9623	156728.4269		
			65.582	140 12 55
233	8240426.5654	156770.3931		
			36.969	122 37 26
234	8240406.6343	156801.5298		
			51.197	16 21 2
235	8240455.7606	156815.9423		
			23.900	52 57 11
236	8240470.1596	156835.0178		
			128.266	88 36 16
237	8240473.2837	156963.2459		
			29.063	44 26 9
238	8240494.0354	156983.5930		
			44.874	340 41 35
239	8240536.3856	156968.7564		
			56.376	351 19 36
240	8240592.1171	156960.2548		
			118.060	16 28 37
241	8240705.3284	156993.7399		
			32.808	54 29 16
242	8240724.3860	157020.4457		
			47.358	86 36 48
243	8240727.1837	157067.7212		
			67.108	37 19 47

244	8240780.5451	157108.4156			
		45.839	56	20	5
245	8240805.9552	157146.5667			
		45.715	26	34	37
246	8240846.8396	157167.0195			
		54.575	12	6	21
247	8240900.2010	157178.4648			
		50.092	311	41	9
248	8240933.5144	157141.0561			
		31.231	339	20	6
249	8240962.7361	157130.0346			
		92.978	5	23	2
250	8241055.3039	157138.7586			
		48.616	346	50	35
251	8241102.6440	157127.6927			
		32.490	359	32	60
252	8241135.1331	157127.4375			
		32.407	34	41	19
253	8241161.7796	157145.8806			
		66.695	60	51	50
254	8241194.2523	157204.1364			
		35.600	17	9	5
255	8241228.2692	157214.6347			
		55.850	311	9	13
256	8241265.0228	157172.5828			
		134.484	38	24	7
257	8241370.4138	157256.1208			
		107.366	44	55	9
258	8241446.4402	157331.9333			
		28.202	89	22	21
259	8241446.7490	157360.1336			
		23.264	119	13	24
260	8241435.3912	157380.4366			
		46.153	149	57	11
261	8241395.4404	157403.5458			
		17.944	71	34	53
262	8241401.1098	157420.5702			
		143.350	8	0	4
263	8241543.0647	157440.5234			
		146.438	359	44	33
264	8241689.5009	157439.8650			
		107.894	55	27	19
265	8241750.6819	157528.7354			
		53.741	358	24	27
266	8241804.4019	157527.2418			
		33.327	34	4	16
267	8241832.0079	157545.9121			
		38.772	91	4	46
268	8241831.2775	157584.6768			
		34.350	66	59	38
269	8241844.7024	157616.2943			
		21.633	21	25	52
270	8241864.8395	157624.1986			
		89.967	303	52	28
271	8241914.9851	157549.5025			
		62.556	48	14	23
272	8241956.6481	157596.1651			
		44.145	350	45	45
273	8242000.2206	157589.0786			
		36.248	23	47	32
274	8242033.3877	157603.7017			
		34.813	116	15	10
275	8242017.9887	157634.9238			
		17.142	64	2	49
276	8242025.4908	157650.3374			
		34.749	0	39	5
277	8242060.2373	157650.7325			
		65.466	32	38	6
278	8242115.3680	157686.0376			
		66.201	44	47	7
279	8242162.3547	157732.6733			
		53.520	25	23	14
280	8242210.7064	157755.6191			

			55.774	32 22 16
281	8242257.8130	157785.4805		
			7.099	351 51 48
282	8242264.8409	157784.4757		
			51.266	294 17 4
283	8242285.9248	157737.7461		
			31.475	33 58 6
284	8242312.0287	157755.3325		
			128.047	54 4 56
285	8242387.1440	157859.0321		
			93.891	48 3 44
286	8242449.8937	157928.8754		
			38.360	316 2 2
287	8242477.5035	157902.2445		
			40.037	13 26 49
288	8242516.4434	157911.5550		
			56.047	95 39 15
289	8242510.9214	157967.3290		
			111.284	34 21 37
290	8242602.7870	158030.1375		
			36.338	130 29 19
291	8242579.1931	158057.7734		
			17.819	68 31 0
292	8242585.7191	158074.3548		
			25.752	345 29 32
293	8242610.6504	158067.9035		
			101.987	303 7 3
294	8242666.3720	157982.4838		
			25.814	346 29 31
295	8242691.4719	157976.4541		
			111.495	68 53 16
296	8242731.6317	158080.4652		
			86.725	116 5 55
297	8242693.4799	158158.3478		
			85.389	42 26 35
298	8242756.4927	158215.9731		
			65.871	87 48 58
299	8242759.0027	158281.7965		
			52.942	56 38 10
300	8242788.1185	158326.0137		
			54.727	358 56 53
301	8242842.8362	158325.0089		
			85.408	48 32 42
302	8242899.3788	158389.0202		
			45.228	8 56 52
303	8242944.0566	158396.0548		
			35.218	75 58 35
304	8242952.5905	158430.2227		
			54.734	47 15 29
305	8242989.7383	158470.4202		
			53.969	114 9 33
306	8242967.6504	158519.6621		
			38.620	10 49 2
307	8243005.5839	158526.9101		
			79.020	57 44 55
308	8243047.7517	158593.7384		
			99.757	35 7 37
309	8243129.3408	158651.1377		
			48.232	54 20 57
310	8243157.4527	158690.3304		
			43.715	90 0 0
311	8243157.4527	158734.0452		
			69.767	10 54 59
312	8243225.9571	158747.2575		
			46.749	61 48 18
313	8243248.0450	158788.4599		
			40.390	38 27 49
314	8243279.6708	158813.5834		
			66.619	352 40 27
315	8243345.7464	158805.0888		
			51.428	75 17 53
316	8243358.7984	158854.8332		
			93.617	22 44 1

317	8243445.1420	158891.0110		
		66.475	55	39 51
318	8243482.6365	158945.9023		
		37.318	340	19 45
319	8243517.7763	158933.3406		
		37.988	290	5 43
320	8243530.8283	158897.6654		
		39.515	78	16 20
321	8243538.8602	158936.3555		
		71.108	353	30 45
322	8243609.5132	158928.3211		
		44.276	80	52 0
323	8243616.5412	158972.0359		
		52.615	7	7 54
324	8243668.7489	158978.5680		
		94.626	324	15 36
325	8243745.5545	158923.2965		
		54.495	87	29 20
326	8243747.9420	158977.7388		
		129.945	30	56 58
327	8243859.3854	159044.5671		
		137.142	51	11 27
328	8243945.3361	159151.4329		
		154.644	104	28 29
329	8243906.6823	159301.1685		
		64.698	155	12 16
330	8243847.9486	159328.3019		
		42.112	129	30 31
331	8243821.1573	159360.7925		
		92.681	99	21 6
332	8243806.0973	159452.2419		
		78.505	113	45 23
333	8243774.4715	159524.0950		
		102.844	8	42 29
334	8243876.1296	159539.6655		
		71.940	305	53 3
335	8243918.2973	159481.3791		
		93.860	31	21 0
336	8243998.4544	159530.2113		
		108.647	15	43 30
337	8244103.0348	159559.6567		
		55.024	49	17 1
338	8244138.9276	159601.3616		
		32.561	27	4 33
339	8244167.9203	159616.1824		
		85.759	307	24 3
340	8244220.0092	159548.0553		
		95.956	51	36 8
341	8244279.6092	159623.2580		
		1906.175	122	1 16
342	8243268.8965	161239.4144		
		349.380	127	14 48
343	8243057.4353	161517.5340		
		327.464	137	22 9
344	8242816.5091	161739.3166		
		343.278	147	24 0
345	8242527.3134	161924.2640		
		320.543	157	19 39
346	8242231.5415	162047.8219		
		3664.711	162	7 14
347	8238743.8187	163172.9419		
		1765.588	251	45 18
348	8238191.0465	161496.1164		
		173.121	243	27 36
349	8238113.6923	161341.2380		
		154.184	227	46 59
350	8238010.0903	161227.0486		
		149.231	213	15 26
351	8237885.3011	161145.2107		
		120.527	200	20 56
352	8237772.2963	161103.2990		
		832.518	194	35 5
353	8236966.6046	160893.6632		

		358.451	285	4	51
354	8237059.8674	160547.5572			
		55.213	296	15	23
355	8237084.2931	160498.0410			
		49.163	317	22	12
356	8237120.4644	160464.7449			
		334.755	327	18	29
357	8237402.1896	160283.9367			
		133.508	317	26	41
358	8237500.5346	160193.6452			
		131.769	297	50	51
359	8237562.0864	160077.1358			
		115.515	279	35	25
360	8237581.3313	159963.2355			
		128.234	261	35	48
361	8237562.5911	159836.3783			
		188.183	252	7	36
362	8237504.8348	159657.2772			
		98.616	241	56	52
363	8237458.4580	159570.2470			
		82.529	223	15	50
364	8237398.3601	159513.6853			
		70.093	207	32	34
365	8237336.2110	159481.2735			
		53.037	194	52	23
366	8237284.9514	159467.6601			
		124.781	189	25	9
367	8237161.8525	159447.2387			
		94.515	200	27	52
368	8237073.3020	159414.1937			
		94.963	222	36	27
369	8237003.4087	159349.9065			
		87.704	243	56	45
370	8236964.8872	159271.1147			
		100.480	265	56	16
371	8236957.7694	159170.8874			
		84.741	287	34	49
372	8236983.3649	159090.1043			
		66.716	305	14	35
373	8237021.8631	159035.6167			
		426.312	313	0	55
374	8237312.6897	158723.9092			
		105.069	302	10	11
375	8237368.6314	158634.9708			
		109.153	280	3	5
376	8237387.6820	158527.4934			
		103.598	258	5	13
377	8237366.2965	158426.1264			
		1150.865	247	23	42
378	8236923.9300	157363.6750			
		149.396	242	4	44
379	8236853.9750	157231.6700			
		208.833	235	35	23
380	8236735.9600	157059.3800			
		275.107	233	33	39
381	8236572.5550	156838.0600			
		754.268	236	11	29
382	8236152.8643	156211.3384			
		298.917	236	55	20
383	8235989.7226	155960.8663			
		223.949	243	45	38
384	8235890.7094	155759.9944			
		499.102	244	38	30
385	8235676.9556	155308.9818			
		469.881	244	14	24
386	8235472.7434	154885.7964			
		118.515	248	17	59
387	8235428.9222	154775.6808			
		119.660	256	27	30
388	8235400.9034	154659.3478			
		444.765	260	33	26
389	8235327.9343	154220.6095			
		96.546	255	19	19

390	8235303.4710	154127.2144			
			81.532	245	40 4
391	8235269.8776	154052.9247			
			904.786	241	14 55
392	8234834.6649	153259.6861			
			94.630	245	49 11
393	8234795.9036	153173.3590			
			116.569	256	1 30
394	8234767.7521	153060.2399			
			82.296	265	37 60
395	8234761.4861	152978.1825			
			840.682	269	36 28
396	8234755.7300	152137.5200			
			85.349	264	52 51
397	8234748.1147	152052.5115			
			88.860	251	2 6
398	8234719.2359	151968.4746			
			98.343	249	35 28
399	8234684.9422	151876.3050			
			74.884	261	41 6
400	8234674.1127	151802.2079			
			76.167	274	45 27
401	8234680.4299	151726.3036			
			80.098	281	2 33
402	8234695.7718	151647.6884			
			97.893	12	15 27
403	8234791.4330	151668.4717			
			80.390	32	39 9
404	8234859.1178	151711.8456			
			39.883	351	59 3
405	8234898.6108	151706.2840			
			100.016	329	0 14
406	8234984.3449	151654.7775			
			106.501	19	23 48
407	8235084.8014	151690.1474			
			177.536	34	2 51
408	8235231.9031	151789.5459			
			69.946	8	7 3
409	8235301.1483	151799.4227			
			211.969	328	22 32
410	8235481.6412	151688.2771			
			135.016	246	56 28
411	8235428.7586	151564.0485			
			112.010	232	14 30
412	8235360.1714	151475.4934			
			47.271	296	2 47
413	8235380.9281	151433.0231			
			103.783	0	0 0
414	8235484.7114	151433.0231			
			344.739	340	34 38
415	8235809.8312	151318.3848			
			72.653	348	10 57
416	8235880.9447	151303.5058			
			74.118	290	55 52
417	8235907.4230	151234.2792			
			64.419	259	28 26
418	8235895.6548	151170.9443			
			44.881	221	29 54
419	8235862.0401	151141.2062			
			66.541	275	4 23
420	8235867.9242	151074.9255			
			113.144	313	24 13
421	8235945.6694	150992.7227			
			46.078	343	16 50
422	8235989.7999	150979.4665			
			87.169	17	29 30
423	8236072.9379	151005.6667			
			90.638	346	50 59
424	8236161.1988	150985.0459			
			66.638	308	37 45
1	8236202.7992	150932.9885			

Região Administrativa de Samambaia
 Lista de Coordenadas do Perímetro

Perímetro: 69807.529 metros
Área: 102924416.203 metros quadrados, ou 10292.4416 hectares

A Área da Região Administrativa de Samambaia, tem seus limites definidos pelo perímetro caracterizado a partir da estação n.º 01 à estação n.º 663, descritos conforme tabela a seguir, extraídas das cartas da CODEPLAN, na escala 1:10000, KR=1.0000000:

ESTAÇÃO	N	E	D(m)	AZ
1	8236202.7992	150932.9885		
		81.671	15 45 55	
2	8236281.3980	150955.1782		
		91.791	340 45 9	
3	8236368.0580	150924.9195		
		49.450	60 56 26	
4	8236392.0766	150968.1445		
		142.475	1 37 22	
5	8236534.4948	150972.1790		
		99.052	9 46 43	
6	8236632.1079	150989.0022		
		27.967	35 14 35	
7	8236654.9485	151005.1402		
		24.638	11 0 49	
8	8236679.1328	151009.8471		
		19.726	324 15 59	
9	8236695.1452	150998.3268		
		52.210	262 36 26	
10	8236688.4274	150946.5509		
		25.772	277 29 19	
11	8236691.7862	150920.9991		
		28.723	10 47 40	
12	8236720.0012	150926.3785		
		29.771	64 36 47	
13	8236732.7651	150953.2750		
		86.846	27 10 54	
14	8236810.0202	150992.9476		
		55.924	16 3 15	
15	8236863.7629	151008.4130		
		52.283	322 48 35	
16	8236905.4135	150976.8096		
		45.707	305 48 46	
17	8236932.1582	150939.7445		
		45.055	357 26 2	
18	8236977.1678	150937.7273		
		29.590	291 17 59	
19	8236987.9164	150910.1582		
		27.580	316 56 53	
20	8237008.0698	150891.3306		
		99.757	12 27 23	
21	8237105.4785	150912.8480		
		68.545	30 48 40	
22	8237164.3488	150947.9572		
		54.562	67 33 43	
23	8237185.1741	150998.3884		
		114.831	24 56 10	
24	8237289.3006	151046.8021		
		60.061	11 42 1	
25	8237348.1141	151058.9820		
		54.990	327 27 3	
26	8237394.4672	151029.3958		
		25.563	356 59 3	
27	8237419.9950	151028.0509		
		54.857	53 59 54	

28	8237452.2406	151072.4304		
		120.104	92	7 57
29	8237447.7717	151192.4512		
		59.375	59	23 37
30	8237478.0019	151243.5547		
		58.670	336	21 3
31	8237531.7446	151220.0203		
		41.832	43	43 29
32	8237561.9749	151248.9341		
		66.210	119	8 41
33	8237529.7292	151306.7617		
		156.710	82	26 37
34	8237550.3371	151462.1103		
		51.334	43	57 58
35	8237587.2851	151497.7483		
		49.409	337	36 3
36	8237632.9664	151478.9206		
		45.633	316	10 0
37	8237665.8839	151447.3172		
		91.911	258	37 6
38	8237647.7457	151357.2136		
		65.747	352	21 35
39	8237712.9087	151348.4723		
		67.949	22	6 18
40	8237775.8632	151374.0418		
		49.952	118	57 25
41	8237751.6790	151417.7489		
		35.180	43	28 43
42	8237777.2068	151441.9557		
		128.507	324	7 24
43	8237881.3333	151366.6453		
		44.465	355	39 49
44	8237925.6710	151363.2832		
		41.827	32	5 5
45	8237961.1099	151385.5007		
		41.262	322	55 3
46	8237994.0273	151360.6213		
		45.778	299	55 49
47	8238016.8680	151320.9488		
		42.313	327	17 42
48	8238052.4725	151298.0867		
		65.126	46	16 53
49	8238097.4820	151345.1557		
		82.958	14	42 33
50	8238177.7213	151366.2198		
		44.461	86	32 6
51	8238180.4084	151410.5991		
		105.079	43	12 46
52	8238256.9918	151482.5475		
		30.218	110	50 12
53	8238246.2432	151510.7889		
		67.674	155	57 35
54	8238184.4391	151538.3580		
		123.938	44	7 14
55	8238273.4116	151624.6402		
		39.966	332	58 56
56	8238309.0160	151606.4849		
		31.869	341	32 56
57	8238339.2463	151596.3987		
		34.556	26	35 12
58	8238370.1484	151611.8643		
		154.060	51	55 20
59	8238465.1619	151733.1358		
		51.202	113	10 45
60	8238445.0084	151780.2048		
		58.882	38	4 23
61	8238491.3615	151816.5152		
		122.885	96	15 59
62	8238477.9486	151938.6656		
		36.858	75	12 60
63	8238487.3535	151974.3035		
		48.821	67	20 19
64	8238506.1635	152019.3553		

			17.024	99	4	55
65	8238503.4764	152036.1656				
			58.001	161	45	32
66	8238448.3901	152054.3208				
			59.408	134	30	53
67	8238406.7395	152096.6830				
			26.111	78	7	20
68	8238412.1138	152122.2347				
			78.835	17	22	10
69	8238487.3535	152145.7693				
			23.829	73	37	30
70	8238494.0714	152168.6314				
			63.305	142	44	21
71	8238443.6876	152206.9591				
			24.474	74	4	7
72	8238450.4055	152230.4935				
			117.961	358	45	19
73	8238568.3391	152227.9308				
			90.084	337	37	27
74	8238651.6403	152193.6376				
			24.417	352	5	9
75	8238675.8246	152190.2757				
			23.019	96	42	14
76	8238673.1374	152213.1377				
			65.592	134	8	34
77	8238627.4561	152260.2068				
			72.629	53	18	24
78	8238670.8543	152318.4438				
			168.431	64	59	24
79	8238742.0634	152471.0820				
			119.963	38	53	12
80	8238835.4414	152546.3925				
			53.357	46	37	45
81	8238872.0827	152585.1791				
			132.473	58	30	42
82	8238941.2764	152698.1449				
			78.932	98	48	44
83	8238929.1843	152776.1450				
			40.618	83	21	6
84	8238933.8868	152816.4898				
			87.559	53	59	45
85	8238985.3577	152887.3225				
			123.099	29	48	25
86	8239092.1713	152948.5122				
			53.761	323	6	16
87	8239135.1655	152916.2363				
			41.469	332	59	53
88	8239172.1136	152897.4087				
			23.519	59	3	36
89	8239184.2057	152917.5811				
			131.674	130	0	14
90	8239099.5609	153018.4433				
			47.027	107	33	29
91	8239085.3741	153063.2798				
			53.648	127	50	56
92	8239052.4567	153105.6420				
			46.196	68	40	53
93	8239069.2513	153148.6765				
			126.558	87	15	42
94	8239075.2973	153275.0905				
			24.667	72	34	5
95	8239082.6870	153298.6250				
			63.689	44	10	19
96	8239128.3682	153343.0044				
			54.402	62	58	42
97	8239153.0846	153391.4677				
			25.085	20	23	38
98	8239176.5971	153400.2091				
			22.585	337	13	47
99	8239197.4223	153391.4677				
			112.492	310	36	43
100	8239270.6468	153306.0710				
			61.307	332	34	14

101	8239325.0613	153277.8297		
		42.755	0	50 53
102	8239367.8119	153278.4626		
		52.820	36	44 60
103	8239410.1343	153310.0661		
		61.888	21	0 39
104	8239467.9077	153332.2557		
		29.744	341	32 57
105	8239496.1226	153322.8420		
		83.339	303	47 36
106	8239542.4757	153253.5832		
		21.213	10	57 51
107	8239563.3011	153257.6177		
		36.771	78	7 59
108	8239570.8626	153293.6027		
		54.562	112	26 17
109	8239550.0373	153344.0338		
		62.259	134	32 9
110	8239506.3714	153388.4131		
		32.263	144	17 53
111	8239480.1717	153407.2408		
		20.323	55	48 33
112	8239491.5921	153424.0512		
		54.945	12	0 28
113	8239545.3348	153435.4821		
		45.048	17	22 10
114	8239588.3289	153448.9305		
		25.878	71	32 47
115	8239596.5202	153473.4779		
		141.652	169	10 2
116	8239457.3922	153500.1008		
		20.868	185	26 42
117	8239436.6188	153498.1207		
		46.537	240	43 54
118	8239413.8670	153457.5249		
		17.835	160	32 36
119	8239397.0504	153463.4657		
		37.130	90	0 0
120	8239397.0504	153500.5959		
		53.871	118	38 57
121	8239371.2224	153547.8712		
		42.160	35	57 15
122	8239405.3501	153572.6248		
		48.383	59	15 39
123	8239430.0803	153614.2105		
		63.438	87	19 7
124	8239433.0480	153677.5795		
		96.906	104	11 50
125	8239409.2808	153771.5258		
		47.125	86	23 22
126	8239412.2484	153818.5573		
		33.185	153	24 49
127	8239382.5721	153833.4093		
		67.448	184	12 33
128	8239315.3058	153828.4587		
		23.354	143	35 24
129	8239296.5108	153842.3206		
		24.452	68	38 51
130	8239305.4137	153865.0938		
		121.583	30	52 3
131	8239409.7754	153927.4726		
		30.492	54	16 18
132	8239427.5811	153952.2260		
		66.694	114	4 19
133	8239400.3779	154013.1195		
		15.836	194	28 59
134	8239385.0451	154009.1590		
		51.139	244	12 0
135	8239362.7879	153963.1176		
		31.570	212	13 12
136	8239336.0792	153946.2852		
		26.427	146	16 51
137	8239314.0981	153960.9554		

			225.588	94 54 19
138	8239294.8085	154185.7169		
			67.644	48 17 20
139	8239339.8175	154236.2140		
			29.495	9 52 48
140	8239368.8750	154241.2749		
			58.111	290 25 27
141	8239389.1538	154186.8174		
			67.578	312 53 45
142	8239435.1520	154137.3103		
			24.281	3 30 25
143	8239459.3876	154138.7956		
			56.810	77 25 43
144	8239471.7527	154194.2434		
			67.686	87 29 17
145	8239474.7192	154261.8641		
			41.574	141 44 24
146	8239442.0753	154287.6077		
			65.480	47 10 14
147	8239486.5897	154335.6294		
			63.616	69 2 40
148	8239509.3415	154395.0377		
			34.793	150 7 51
149	8239479.1706	154412.3652		
			99.887	187 58 37
150	8239380.2497	154398.5032		
			122.071	89 50 35
151	8239380.5843	154520.5734		
			70.651	106 15 42
152	8239360.8001	154588.3979		
			52.205	9 49 42
153	8239412.2390	154597.3092		
			18.945	40 47 25
154	8239426.5825	154609.6859		
			35.429	105 22 54
155	8239417.1851	154643.8458		
			70.840	153 45 28
156	8239353.6464	154675.1688		
			45.390	200 25 39
157	8239311.1104	154659.3265		
			72.223	245 44 19
158	8239281.4340	154593.4822		
			29.654	207 52 11
159	8239255.2199	154579.6203		
			26.630	144 48 30
160	8239233.4573	154594.9674		
			94.409	80 20 56
161	8239249.2847	154688.0405		
			51.696	59 31 49
162	8239275.4987	154732.5968		
			74.554	34 11 53
163	8239337.1618	154774.5001		
			54.941	321 33 21
164	8239380.1924	154740.3403		
			15.405	354 28 2
165	8239395.5252	154738.8551		
			17.623	51 52 8
166	8239406.4065	154752.7170		
			87.313	105 26 27
167	8239383.1601	154836.8788		
			110.780	21 46 21
168	8239486.0379	154877.9695		
			31.578	76 24 42
169	8239493.4570	154908.6638		
			33.249	143 26 44
170	8239466.7483	154928.4666		
			40.418	201 33 34
171	8239429.1583	154913.6145		
			23.036	165 3 18
172	8239406.9011	154919.5554		
			107.548	113 52 19
173	8239363.3771	155017.9033		
			26.631	48 2 22

174	8239381.1828	155037.7060	66.743	11 59 13
175	8239446.4706	155051.5679	58.339	331 35 57
176	8239497.7877	155023.8200	35.010	23 19 28
177	8239529.9370	155037.6820	73.606	57 56 14
178	8239569.0107	155100.0608	76.977	357 58 20
179	8239645.9397	155097.3371	52.001	25 22 1
180	8239692.9272	155119.6152	17.929	39 25 37
181	8239706.7761	155131.0017	26.054	104 17 15
182	8239700.3462	155156.2503	113.402	142 57 15
183	8239609.8336	155224.5699	20.684	68 58 49
184	8239617.2527	155243.8775	96.543	21 59 1
185	8239706.7761	155280.0176	62.033	0 34 21
186	8239768.8060	155280.6374	93.987	66 25 30
187	8239806.3959	155366.7796	31.440	117 3 18
188	8239792.0954	155394.7793	56.542	60 5 30
189	8239820.2879	155443.7913	212.963	93 19 49
190	8239807.9168	155656.3950	43.367	154 17 28
191	8239768.8430	155675.2075	62.569	53 28 28
192	8239806.0829	155725.4876	74.738	107 35 40
193	8239783.4912	155796.7298	48.382	78 53 50
194	8239792.8082	155844.2067	56.631	44 7 3
195	8239833.4645	155883.6296	37.047	349 27 4
196	8239869.8858	155876.8471	47.307	357 3 60
197	8239917.1308	155874.4261	59.931	43 52 52
198	8239960.3281	155915.9684	45.616	15 4 55
199	8240004.3724	155927.8376	21.316	72 39 41
200	8240010.7249	155948.1849	134.631	118 1 29
201	8239947.4686	156067.0296	33.067	90 44 2
202	8239947.0451	156100.0938	18.957	100 17 44
203	8239943.6570	156118.7454	18.807	172 13 39
204	8239925.0229	156121.2888	49.486	241 55 16
205	8239901.7303	156077.6270	21.051	229 55 32
206	8239888.1782	156061.5188	30.688	153 46 2
207	8239860.6505	156075.0836	30.311	110 26 40
208	8239850.0630	156103.4850	38.303	62 54 51
209	8239867.5032	156137.5869	81.713	38 30 2
210	8239931.4522	156188.4550		

			56.207	3 55 8
211	8239987.5273	156192.2965		
			29.318	37 23 33
212	8240010.8200	156210.1002		
			105.132	93 49 2
213	8240003.8209	156314.9992		
			42.548	45 50 2
214	8240033.4660	156345.5201		
			102.946	25 53 9
215	8240126.0832	156390.4643		
			56.899	351 51 45
216	8240182.4091	156382.4102		
			54.291	327 24 5
217	8240228.1473	156353.1609		
			54.507	338 6 11
218	8240278.7221	156332.8331		
			36.484	9 21 42
219	8240314.7198	156338.7677		
			26.736	92 43 25
220	8240313.4494	156365.4734		
			127.148	122 40 13
221	8240244.8143	156472.5051		
			28.696	148 52 2
222	8240220.2511	156487.3417		
			18.207	77 54 58
223	8240224.0627	156505.1455		
			78.475	38 0 34
224	8240285.8941	156553.4701		
			49.930	21 32 31
225	8240332.3361	156571.8034		
			33.821	52 9 4
226	8240353.0878	156598.5092		
			60.407	337 43 55
227	8240408.9901	156575.6185		
			43.434	357 46 48
228	8240452.3919	156573.9361		
			29.457	40 21 35
229	8240474.8376	156593.0117		
			40.873	95 21 3
230	8240471.0261	156633.7061		
			47.809	79 47 44
231	8240479.4961	156680.7589		
			47.735	93 2 34
232	8240476.9623	156728.4269		
			65.582	140 12 55
233	8240426.5654	156770.3931		
			36.969	122 37 26
234	8240406.6343	156801.5298		
			51.197	16 21 2
235	8240455.7606	156815.9423		
			23.900	52 57 11
236	8240470.1596	156835.0178		
			128.266	88 36 16
237	8240473.2837	156963.2459		
			29.063	44 26 9
238	8240494.0354	156983.5930		
			44.874	340 41 35
239	8240536.3856	156968.7564		
			56.376	351 19 36
240	8240592.1171	156960.2548		
			118.060	16 28 37
241	8240705.3284	156993.7399		
			32.808	54 29 16
242	8240724.3860	157020.4457		
			47.358	86 36 48
243	8240727.1837	157067.7212		
			67.108	37 19 47
244	8240780.5451	157108.4156		
			45.839	56 20 5
245	8240805.9552	157146.5667		
			45.715	26 34 37
246	8240846.8396	157167.0195		
			54.575	12 6 21

247	8240900.2010	157178.4648			
		50.092	311	41	9
248	8240933.5144	157141.0561			
		31.231	339	20	6
249	8240962.7361	157130.0346			
		92.978	5	23	2
250	8241055.3039	157138.7586			
		48.616	346	50	35
251	8241102.6440	157127.6927			
		32.490	359	32	60
252	8241135.1331	157127.4375			
		32.407	34	41	19
253	8241161.7796	157145.8806			
		66.695	60	51	50
254	8241194.2523	157204.1364			
		35.600	17	9	5
255	8241228.2692	157214.6347			
		55.850	311	9	13
256	8241265.0228	157172.5828			
		134.484	38	24	7
257	8241370.4138	157256.1208			
		107.366	44	55	9
258	8241446.4402	157331.9333			
		28.202	89	22	21
259	8241446.7490	157360.1336			
		23.264	119	13	24
260	8241435.3912	157380.4366			
		46.153	149	57	11
261	8241395.4404	157403.5458			
		17.944	71	34	53
262	8241401.1098	157420.5702			
		143.350	8	0	4
263	8241543.0647	157440.5234			
		146.438	359	44	33
264	8241689.5009	157439.8650			
		107.894	55	27	19
265	8241750.6819	157528.7354			
		53.741	358	24	27
266	8241804.4019	157527.2418			
		33.327	34	4	16
267	8241832.0079	157545.9121			
		38.772	91	4	46
268	8241831.2775	157584.6768			
		34.350	66	59	38
269	8241844.7024	157616.2943			
		21.633	21	25	52
270	8241864.8395	157624.1986			
		89.967	303	52	28
271	8241914.9851	157549.5025			
		62.556	48	14	23
272	8241956.6481	157596.1651			
		44.145	350	45	45
273	8242000.2206	157589.0786			
		36.248	23	47	32
274	8242033.3877	157603.7017			
		34.813	116	15	10
275	8242017.9887	157634.9238			
		17.142	64	2	49
276	8242025.4908	157650.3374			
		34.749	0	39	5
277	8242060.2373	157650.7325			
		65.466	32	38	6
278	8242115.3680	157686.0376			
		66.201	44	47	7
279	8242162.3547	157732.6733			
		53.520	25	23	14
280	8242210.7064	157755.6191			
		55.774	32	22	16
281	8242257.8130	157785.4805			
		7.099	351	51	48
282	8242264.8409	157784.4757			
		51.266	294	17	4
283	8242285.9248	157737.7461			

		31.475	33 58 6
284	8242312.0287	157755.3325	
		128.047	54 4 56
285	8242387.1440	157859.0321	
		93.891	48 3 44
286	8242449.8937	157928.8754	
		38.360	316 2 2
287	8242477.5035	157902.2445	
		40.037	13 26 49
288	8242516.4434	157911.5550	
		56.047	95 39 15
289	8242510.9214	157967.3290	
		111.284	34 21 37
290	8242602.7870	158030.1375	
		36.338	130 29 19
291	8242579.1931	158057.7734	
		17.819	68 31 0
292	8242585.7191	158074.3548	
		25.752	345 29 32
293	8242610.6504	158067.9035	
		101.987	303 7 3
294	8242666.3720	157982.4838	
		25.814	346 29 31
295	8242691.4719	157976.4541	
		111.495	68 53 16
296	8242731.6317	158080.4652	
		86.725	116 5 55
297	8242693.4799	158158.3478	
		85.389	42 26 35
298	8242756.4927	158215.9731	
		65.871	87 48 58
299	8242759.0027	158281.7965	
		52.942	56 38 10
300	8242788.1185	158326.0137	
		54.727	358 56 53
301	8242842.8362	158325.0089	
		85.408	48 32 42
302	8242899.3788	158389.0202	
		45.228	8 56 52
303	8242944.0566	158396.0548	
		35.218	75 58 35
304	8242952.5905	158430.2227	
		54.734	47 15 29
305	8242989.7383	158470.4202	
		53.969	114 9 33
306	8242967.6504	158519.6621	
		38.620	10 49 2
307	8243005.5839	158526.9101	
		79.020	57 44 55
308	8243047.7517	158593.7384	
		99.757	35 7 37
309	8243129.3408	158651.1377	
		48.232	54 20 57
310	8243157.4527	158690.3304	
		43.715	90 0 0
311	8243157.4527	158734.0452	
		69.767	10 54 59
312	8243225.9571	158747.2575	
		46.749	61 48 18
313	8243248.0450	158788.4599	
		40.390	38 27 49
314	8243279.6708	158813.5834	
		66.619	352 40 27
315	8243345.7464	158805.0888	
		51.428	75 17 53
316	8243358.7984	158854.8332	
		93.617	22 44 1
317	8243445.1420	158891.0110	
		66.475	55 39 51
318	8243482.6365	158945.9023	
		37.318	340 19 45
319	8243517.7763	158933.3406	
		37.988	290 5 43

320	8243530.8283	158897.6654		
		39.515	78	16 20
321	8243538.8602	158936.3555		
		71.108	353	30 45
322	8243609.5132	158928.3211		
		44.276	80	52 0
323	8243616.5412	158972.0359		
		52.615	7	7 54
324	8243668.7489	158978.5680		
		94.626	324	15 36
325	8243745.5545	158923.2965		
		54.495	87	29 20
326	8243747.9420	158977.7388		
		129.945	30	56 58
327	8243859.3854	159044.5671		
		137.142	51	11 27
328	8243945.3361	159151.4329		
		154.644	104	28 29
329	8243906.6823	159301.1685		
		64.698	155	12 16
330	8243847.9486	159328.3019		
		42.112	129	30 31
331	8243821.1573	159360.7925		
		92.681	99	21 6
332	8243806.0973	159452.2419		
		78.505	113	45 23
333	8243774.4715	159524.0950		
		102.844	8	42 29
334	8243876.1296	159539.6655		
		71.940	305	53 3
335	8243918.2973	159481.3791		
		93.860	31	21 0
336	8243998.4544	159530.2113		
		108.647	15	43 30
337	8244103.0348	159559.6567		
		55.024	49	17 1
338	8244138.9276	159601.3616		
		32.561	27	4 33
339	8244167.9203	159616.1824		
		85.759	307	24 3
340	8244220.0092	159548.0553		
		95.956	51	36 8
341	8244279.6092	159623.2580		
		61.825	46	49 26
342	8244321.9127	159668.3442		
		130.778	58	37 31
343	8244390.0000	159780.0000		
		76.736	46	50 49
344	8244442.4834	159835.9810		
		23.184	114	28 60
345	8244432.8751	159857.0808		
		72.364	201	28 27
346	8244365.5346	159830.5898		
		132.400	69	50 5
347	8244411.1767	159954.8741		
		101.471	351	42 54
348	8244511.5892	159940.2524		
		210.187	90	0 0
349	8244511.5892	160150.4389		
		84.641	57	22 5
350	8244557.2313	160221.7196		
		100.566	338	1 11
351	8244650.4875	160184.0792		
		71.019	109	38 55
352	8244626.6073	160250.9629		
		252.546	71	27 11
353	8244706.9373	160490.3927		
		95.177	0	45 46
354	8244802.1061	160491.6596		
		91.053	98	13 0
355	8244789.0930	160581.7783		
		63.151	48	2 22
356	8244831.3171	160628.7378		

			115.849	127 55 24
357	8244760.1155	160720.1232		
			69.040	18 3 48
358	8244825.7530	160741.5305		
			155.507	109 54 19
359	8244772.8082	160887.7473		
			227.483	39 34 15
360	8244948.1607	161032.6615		
			173.811	129 4 50
361	8244838.5877	161167.5840		
			115.338	83 30 5
362	8244851.6414	161282.1814		
			111.104	142 41 6
363	8244763.2783	161349.5324		
			79.420	90 43 28
364	8244762.2742	161428.9464		
			121.432	141 0 47
365	8244667.8864	161505.3447		
			30.245	114 2 50
366	8244655.5620	161532.9643		
			39.208	152 12 55
367	8244620.8741	161551.2414		
			80.349	107 10 50
368	8244597.1402	161628.0052		
			46.692	59 26 55
369	8244620.8741	161668.2147		
			60.319	106 15 28
370	8244603.9874	161726.1216		
			86.569	77 16 6
371	8244623.0657	161810.5618		
			79.524	69 17 43
372	8244651.1813	161884.9495		
			90.992	118 17 11
373	8244608.0623	161965.0758		
			70.479	16 34 28
374	8244675.6125	161985.1807		
			48.767	102 58 51
375	8244664.6584	162032.7011		
			68.037	174 20 19
376	8244596.9535	162039.4128		
			98.560	91 45 5
377	8244593.9411	162137.9263		
			83.087	57 52 35
378	8244638.1226	162208.2930		
			106.781	75 50 53
379	8244664.2299	162311.8329		
			46.296	62 54 16
380	8244685.3165	162353.0477		
			83.847	85 23 53
381	8244692.0437	162436.6248		
			114.495	125 46 30
382	8244625.1092	162529.5169		
			87.687	193 15 17
383	8244539.7586	162509.4121		
			73.329	124 13 9
384	8244498.5213	162570.0476		
			66.547	68 42 20
385	8244522.6885	162632.0514		
			48.258	121 20 41
386	8244497.5853	162673.2662		
			69.717	95 47 11
387	8244490.5564	162742.6279		
			136.877	154 47 27
388	8244366.7160	162800.9270		
			133.438	76 10 25
389	8244398.6049	162930.4988		
			36.768	123 39 39
390	8244378.2252	162961.1023		
			175.243	159 15 37
391	8244214.3383	163023.1595		
			83.267	114 18 42
392	8244180.0572	163099.0421		
			28.837	45 1 55

393	8244200.4369	163119.4445		
			33.389	7 18 49
394	8244233.5540	163123.6949		
			24.512	123 39 39
395	8244219.9675	163144.0973		
			52.226	156 47 8
396	8244171.9702	163164.6833		
			44.889	108 45 31
397	8244157.5346	163207.1882		
			50.309	158 10 36
398	8244110.8311	163225.8904		
			56.919	178 17 18
399	8244053.9376	163227.5906		
			36.022	250 43 48
400	8244042.0495	163193.5867		
			31.705	187 42 16
401	8244010.6308	163189.3362		
			33.049	133 55 36
402	8243987.7036	163213.1389		
			37.317	59 57 32
403	8244006.3850	163245.4426		
			37.038	36 38 15
404	8244036.1054	163267.5452		
			28.762	71 2 57
405	8244045.4461	163294.7482		
			25.508	143 16 44
406	8244025.0000	163310.0000		
			109.388	142 51 24
407	8243937.8036	163376.0497		
			83.629	100 10 29
408	8243923.0304	163458.3635		
			33.467	143 12 4
409	8243896.2321	163478.4104		
			104.084	97 23 22
410	8243882.8456	163581.6303		
			109.078	132 9 16
411	8243809.6402	163662.4937		
			53.897	113 12 2
412	8243788.4075	163712.0317		
			62.075	79 15 43
413	8243799.9731	163773.0195		
			75.785	129 20 15
414	8243751.9339	163831.6339		
			44.296	107 2 3
415	8243738.9579	163873.9864		
			66.849	160 41 55
416	8243675.8662	163896.0826		
			115.860	100 33 18
417	8243654.6430	164009.9824		
			55.591	96 27 40
418	8243648.3875	164065.2201		
			64.018	145 56 6
419	8243595.3550	164101.0787		
			182.328	77 9 19
420	8243635.8880	164278.8446		
			138.117	41 17 22
421	8243739.6675	164369.9829		
			69.193	96 17 14
422	8243732.0899	164438.7598		
			67.664	136 9 23
423	8243683.2887	164485.6300		
			70.205	156 11 47
424	8243619.0557	164513.9650		
			74.388	122 34 49
425	8243578.9993	164576.6468		
			88.458	47 57 36
426	8243638.2356	164642.3428		
			116.147	131 13 49
427	8243561.6846	164729.6929		
			49.396	79 28 13
428	8243570.7114	164778.2572		
			90.746	137 50 39
429	8243503.4393	164839.1611		

			184.424	103	0	60
430	8243461.9011	165018.8461				
			116.245	131	48	58
431	8243384.3957	165105.4819				
			102.357	116	27	17
432	8243338.7968	165197.1208				
			104.794	141	38	39
433	8243256.6204	165262.1497				
			114.246	49	40	3
434	8243330.5632	165349.2399				
			60.382	32	0	21
435	8243381.7665	165381.2424				
			145.628	71	55	15
436	8243426.9595	165519.6801				
			115.631	55	46	40
437	8243491.9912	165615.2911				
			71.462	133	41	35
438	8243442.6259	165666.9614				
			98.790	161	46	21
439	8243348.7928	165697.8620				
			82.293	110	9	14
440	8243320.4392	165775.1161				
			70.791	85	39	28
441	8243325.7989	165845.7037				
			59.467	119	19	53
442	8243296.6685	165897.5467				
			119.826	67	58	58
443	8243341.5897	166008.6337				
			99.522	127	47	38
444	8243280.6003	166087.2783				
			147.843	88	28	28
445	8243284.5360	166235.0688				
			64.713	106	29	36
446	8243266.1635	166297.1193				
			68.632	69	2	53
447	8243290.7052	166361.2129				
			130.458	107	29	25
448	8243251.4970	166485.6399				
			129.404	65	4	53
449	8243306.0187	166602.9973				
			77.628	50	46	51
450	8243355.1019	166663.1380				
			48.249	90	31	58
451	8243354.6532	166711.3853				
			79.958	45	33	42
452	8243410.6350	166768.4755				
			62.745	19	44	19
453	8243469.6932	166789.6664				
			70.684	359	33	17
454	8243540.3754	166789.1170				
			185.473	27	41	35
455	8243704.6022	166875.3126				
			54.505	7	15	17
456	8243758.6706	166882.1956				
			80.387	321	49	0
457	8243821.8581	166832.5019				
			84.428	10	47	39
458	8243904.7919	166848.3135				
			270.709	41	45	13
459	8244106.7447	167028.5864				
			109.163	47	53	37
460	8244179.9392	167109.5743				
			89.814	20	36	57
461	8244264.0013	167141.1976				
			121.827	62	29	56
462	8244320.2569	167249.2579				
			97.964	19	10	55
463	8244412.7816	167281.4459				
			106.782	88	11	0
464	8244416.1667	167388.1745				
			114.733	75	21	13
465	8244445.1774	167499.1790				
			94.684	112	25	1

466	8244409.0702	167586.7078		
		138.118	38	43 21
467	8244516.8277	167673.1071		
		56.856	97	46 16
468	8244509.1399	167729.4406		
		206.726	65	50 6
469	8244593.7661	167918.0509		
		78.698	33	17 21
470	8244659.5502	167961.2454		
		88.503	102	31 3
471	8244640.3683	168047.6448		
		175.731	59	5 29
472	8244730.6363	168198.4201		
		59.227	88	10 37
473	8244732.5204	168257.6170		
		138.980	47	0 6
474	8244827.3018	168359.2633		
		60.611	117	44 12
475	8244799.0930	168412.9100		
		82.331	62	13 37
476	8244837.4569	168485.7564		
		84.099	87	9 3
477	8244841.6372	168569.7510		
		86.309	51	7 56
478	8244895.7980	168636.9505		
		83.255	104	50 38
479	8244874.4694	168717.4271		
		151.018	82	16 15
480	8244894.7797	168867.0730		
		43.768	59	49 12
481	8244916.7826	168904.9080		
		61.506	22	6 47
482	8244973.7642	168928.0608		
		123.173	83	18 39
483	8244988.1119	169050.3952		
		256.299	49	56 40
484	8245153.0480	169246.5723		
		61.581	58	31 10
485	8245185.2060	169299.0894		
		60.118	101	5 50
486	8245173.6350	169358.0830		
		92.220	26	7 5
487	8245256.4385	169398.6803		
		67.218	86	43 54
488	8245260.2707	169465.7891		
		82.368	29	15 54
489	8245332.1256	169506.0544		
		54.931	60	46 3
490	8245358.9513	169553.9892		
		61.803	29	45 40
491	8245412.6029	169584.6675		
		84.492	65	11 38
492	8245448.0513	169661.3633		
		59.137	333	0 16
493	8245500.7449	169634.5198		
		74.235	32	16 27
494	8245563.5108	169674.1592		
		92.251	42	29 34
495	8245631.5333	169736.4745		
		91.081	90	36 10
496	8245630.5753	169827.5507		
		119.509	59	7 54
497	8245691.8913	169930.1313		
		91.568	70	26 20
498	8245722.5494	170016.4141		
		37.924	106	8 3
499	8245712.0107	170052.8445		
		121.994	51	4 39
500	8245788.6558	170147.7555		
		59.191	74	36 32
501	8245804.3655	170204.8241		
		45.528	40	45 3
502	8245838.8558	170234.5437		

			50.082	84 30 41
503	8245843.6461	170284.3960		
			86.908	41 26 32
504	8245908.7945	170341.9177		
			50.632	29 29 32
505	8245952.8654	170366.8439		
			59.509	87 13 53
506	8245955.7397	170426.2831		
			40.866	50 43 45
507	8245981.6074	170457.9201		
			45.942	83 38 42
508	8245986.6927	170503.5800		
			71.722	81 33 2
509	8245997.2314	170574.5236		
			120.959	72 0 25
510	8246034.5959	170689.5672		
			549.114	166 47 44
511	8245500.0000	170815.0000		
			172.047	125 32 16
512	8245400.0000	170955.0000		
			305.287	148 23 33
513	8245140.0000	171115.0000		
			130.245	82 4 30
514	8245157.9577	171244.0015		
			637.774	149 0 20
515	8244611.2466	171572.4265		
			86.961	144 51 26
516	8244540.1371	171622.4826		
			87.191	136 32 57
517	8244476.8396	171682.4464		
			87.191	128 13 49
518	8244422.8838	171750.9373		
			87.191	119 54 41
519	8244379.4051	171826.5139		
			87.191	111 35 34
520	8244347.3184	171907.5860		
			87.191	103 16 26
521	8244327.2990	171992.4473		
			87.191	94 57 18
522	8244319.7682	172079.3123		
			87.191	86 38 10
523	8244324.8844	172166.3528		
			87.191	78 19 2
524	8244342.5400	172251.7373		
			87.191	69 59 54
525	8244372.3634	172333.6689		
			541.982	65 50 20
526	8244594.1987	172828.1721		
			202.258	135 28 30
527	8244450.0000	172970.0000		
			398.989	137 35 52
528	8244155.3753	173239.0508		
			113.217	61 59 46
529	8244208.5343	173339.0116		
			78.658	65 32 51
530	8244241.0942	173410.6147		
			52.769	70 7 25
531	8244259.0353	173460.2405		
			23.673	134 1 13
532	8244242.5843	173477.2639		
			87.659	126 16 42
533	8244190.7157	173547.9304		
			23.353	135 2 50
534	8244174.1890	173564.4299		
			56.999	154 55 40
535	8244122.5603	173588.5839		
			12.483	120 40 60
536	8244116.1905	173599.3190		
			55.969	143 18 27
537	8244071.3118	173632.7614		
			44.895	123 26 58
538	8244046.5658	173670.2203		
			28.580	148 54 15

539	8244022.0924	173684.9811		
			30.492	156 14 15
540	8243994.1854	173697.2677		
			85.560	134 45 21
541	8243933.9437	173758.0248		
			29.355	139 12 50
542	8243911.7174	173777.2007		
			18.436	121 12 54
543	8243902.1628	173792.9679		
			56.468	139 34 42
544	8243859.1738	173829.5825		
			27.781	128 25 15
545	8243841.9096	173851.3482		
			89.752	81 4 55
546	8243855.8230	173940.0150		
			312.264	91 39 53
547	8243846.7510	174252.1470		
			89.731	61 34 45
548	8243889.4580	174331.0630		
			650.444	152 28 30
549	8243312.6376	174631.6552		
			1255.568	234 37 60
550	8242585.9054	173607.7839		
			28.913	140 34 50
551	8242563.5698	173626.1432		
			1158.246	234 32 44
552	8241891.7220	172682.6636		
			972.924	252 18 38
553	8241596.0906	171755.7426		
			263.410	246 44 8
554	8241492.0500	171513.7500		
			1344.315	251 32 46
555	8241066.5165	170238.5619		
			1511.122	251 59 22
556	8240599.2903	168801.4849		
			7692.077	251 45 18
557	8238191.0465	161496.1164		
			173.121	243 27 36
558	8238113.6923	161341.2380		
			154.184	227 46 59
559	8238010.0903	161227.0486		
			149.231	213 15 26
560	8237885.3011	161145.2107		
			120.527	200 20 56
561	8237772.2963	161103.2990		
			832.518	194 35 5
562	8236966.6046	160893.6632		
			358.451	285 4 51
563	8237059.8674	160547.5572		
			55.213	296 15 23
564	8237084.2931	160498.0410		
			49.163	317 22 12
565	8237120.4644	160464.7449		
			334.755	327 18 29
566	8237402.1896	160283.9367		
			133.508	317 26 41
567	8237500.5346	160193.6452		
			131.769	297 50 51
568	8237562.0864	160077.1358		
			115.515	279 35 25
569	8237581.3313	159963.2355		
			128.234	261 35 48
570	8237562.5911	159836.3783		
			188.183	252 7 36
571	8237504.8348	159657.2772		
			98.616	241 56 52
572	8237458.4580	159570.2470		
			82.529	223 15 50
573	8237398.3601	159513.6853		
			70.093	207 32 34
574	8237336.2110	159481.2735		
			53.037	194 52 23
575	8237284.9514	159467.6601		

			124.781	189 25 9
576	8237161.8525	159447.2387		
			94.515	200 27 52
577	8237073.3020	159414.1937		
			94.963	222 36 27
578	8237003.4087	159349.9065		
			87.704	243 56 45
579	8236964.8872	159271.1147		
			100.480	265 56 16
580	8236957.7694	159170.8874		
			84.741	287 34 49
581	8236983.3649	159090.1043		
			66.716	305 14 35
582	8237021.8631	159035.6167		
			426.312	313 0 55
583	8237312.6897	158723.9092		
			105.069	302 10 11
584	8237368.6314	158634.9708		
			109.153	280 3 5
585	8237387.6820	158527.4934		
			103.598	258 5 13
586	8237366.2965	158426.1264		
			1150.865	247 23 42
587	8236923.9300	157363.6750		
			149.396	242 4 44
588	8236853.9750	157231.6700		
			208.833	235 35 23
589	8236735.9600	157059.3800		
			275.107	233 33 39
590	8236572.5550	156838.0600		
			754.268	236 11 29
591	8236152.8643	156211.3384		
			298.917	236 55 20
592	8235989.7226	155960.8663		
			223.949	243 45 38
593	8235890.7094	155759.9944		
			499.102	244 38 30
594	8235676.9556	155308.9818		
			469.881	244 14 24
595	8235472.7434	154885.7964		
			118.515	248 17 59
596	8235428.9222	154775.6808		
			119.660	256 27 30
597	8235400.9034	154659.3478		
			444.765	260 33 26
598	8235327.9343	154220.6095		
			96.546	255 19 19
599	8235303.4710	154127.2144		
			81.532	245 40 4
600	8235269.8776	154052.9247		
			904.786	241 14 55
601	8234834.6649	153259.6861		
			94.630	245 49 11
602	8234795.9036	153173.3590		
			116.569	256 1 30
603	8234767.7521	153060.2399		
			82.296	265 37 60
604	8234761.4861	152978.1825		
			840.682	269 36 28
605	8234755.7300	152137.5200		
			85.349	264 52 51
606	8234748.1147	152052.5115		
			88.860	251 2 6
607	8234719.2359	151968.4746		
			98.343	249 35 28
608	8234684.9422	151876.3050		
			74.884	261 41 6
609	8234674.1127	151802.2079		
			76.167	274 45 27
610	8234680.4299	151726.3036		
			80.098	281 2 33
611	8234695.7718	151647.6884		
			97.893	12 15 27

612	8234791.4330	151668.4717			
			80.390	32	39 9
613	8234859.1178	151711.8456			
			39.883	351	59 3
614	8234898.6108	151706.2840			
			100.016	329	0 14
615	8234984.3449	151654.7775			
			106.501	19	23 48
616	8235084.8014	151690.1474			
			177.536	34	2 51
617	8235231.9031	151789.5459			
			69.946	8	7 3
618	8235301.1483	151799.4227			
			211.969	328	22 32
619	8235481.6412	151688.2771			
			135.016	246	56 28
620	8235428.7586	151564.0485			
			112.010	232	14 30
621	8235360.1714	151475.4934			
			47.271	296	2 47
622	8235380.9281	151433.0231			
			103.783	0	0 0
623	8235484.7114	151433.0231			
			344.739	340	34 38
624	8235809.8312	151318.3848			
			72.653	348	10 57
625	8235880.9447	151303.5058			
			74.118	290	55 52
626	8235907.4230	151234.2792			
			64.419	259	28 26
627	8235895.6548	151170.9443			
			44.881	221	29 54
628	8235862.0401	151141.2062			
			66.541	275	4 23
629	8235867.9242	151074.9255			
			113.144	313	24 13
630	8235945.6694	150992.7227			
			46.078	343	16 50
631	8235989.7999	150979.4665			
			87.169	17	29 30
632	8236072.9379	151005.6667			
			90.638	346	50 59
633	8236161.1988	150985.0459			
			66.638	308	37 45
1	8236202.7992	150932.9885			

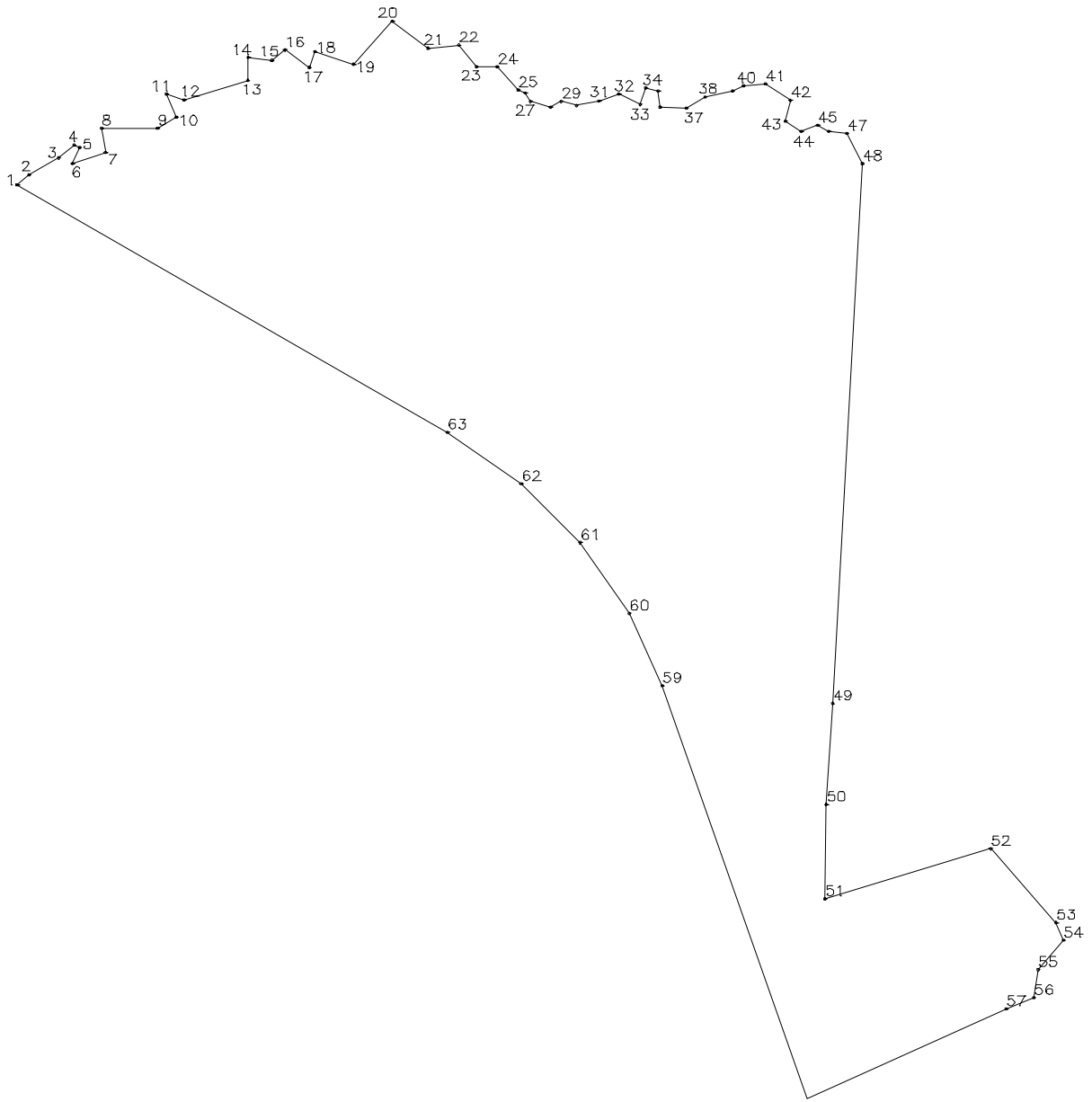

**PLANO DIRETOR LOCAL
SAMAMBAIA - RA XII**

SECRETARIA DE ESTADO DE DESENVOLVIMENTO URBANO E HABITAÇÃO
SUBSECRETARIA DE URBANISMO E PRESERVAÇÃO-SUDUR

ÁREA DE DESENVOLVIMENTO ECONÔMICO OESTE

DESCRIÇÃO DOS PERÍMETROS

DESENHO:
Ana Carla

DATA:
Mar./2001

ESCALA:
1/25000

ARQUIVO
12ADESTE

LOCALIZAÇÃO:

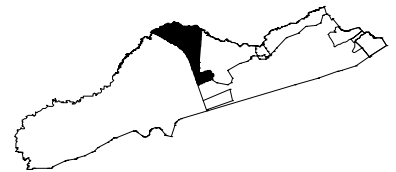

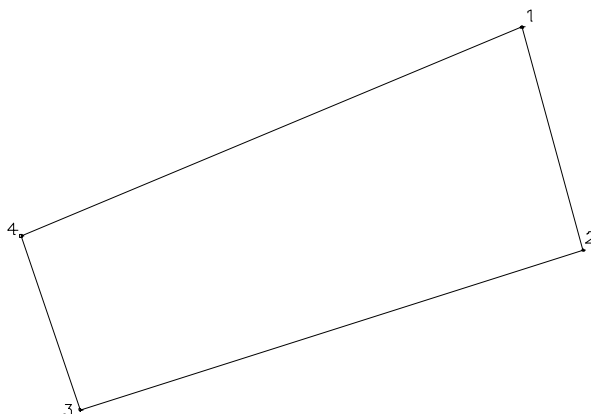

**PLANO DIRETOR LOCAL
SAMAMBAIA - RA XII**

SECRETARIA DE ESTADO DE DESENVOLVIMENTO URBANO E HABITAÇÃO
SUBSECRETARIA DE URBANISMO E PRESERVAÇÃO-SUDUR

ÁREA RURAL REMANESCENTE – ARR Veredas

DESCRIÇÃO DOS PERÍMETROS

DESENHO:
Ana Carla

DATA:
Mar./2001

ESCALA:
1/25000

ARQUIVO
12ARR2

LOCALIZAÇÃO:

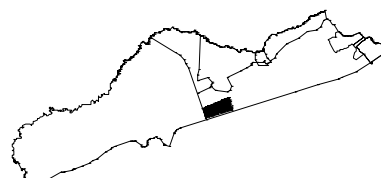

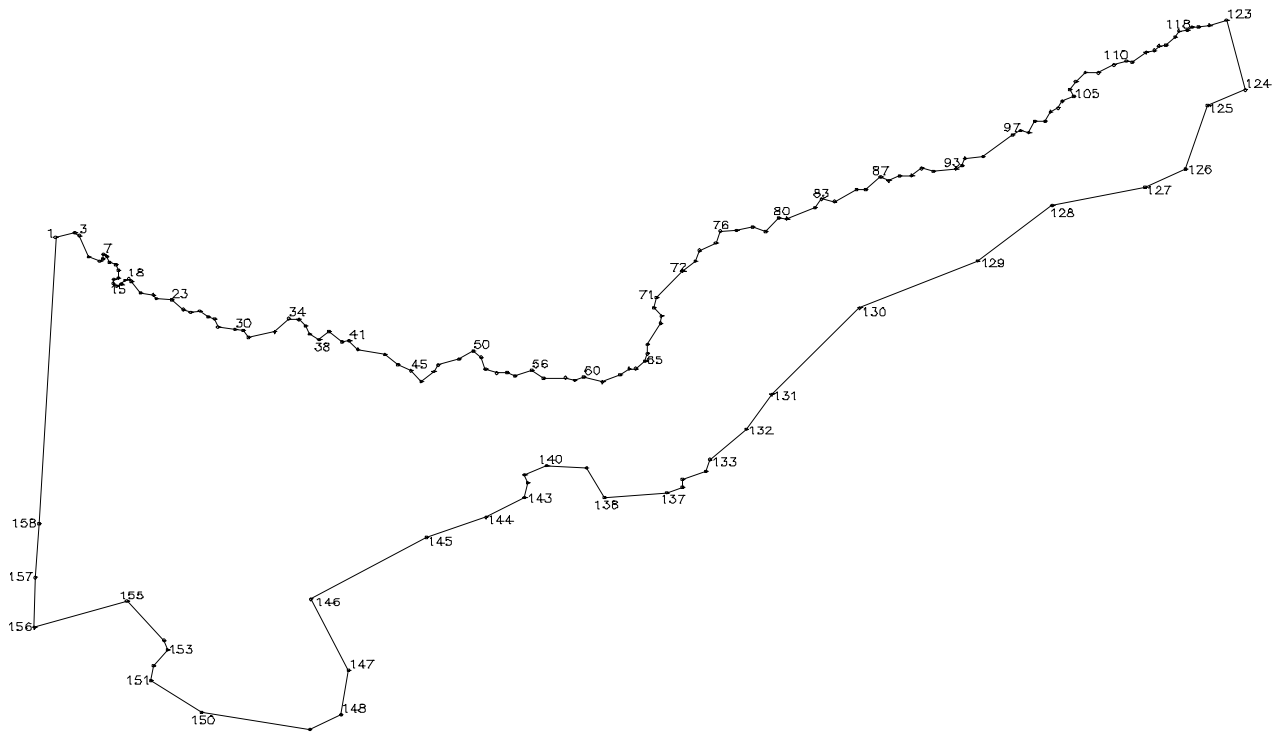

**PLANO DIRETOR LOCAL
SAMAMBAIA - RA XII**

SECRETARIA DE ESTADO DE DESENVOLVIMENTO URBANO E HABITAÇÃO
SUBSECRETARIA DE URBANISMO E PRESERVAÇÃO-SUDUR

ÁREA RURAL REMANESCENTE — ARR Taguatinga

DESCRIÇÃO DOS PERÍMETROS

DESENHO:
Ana Carla

DATA:
Mar./2001

ESCALA:
1/25000

ARQUIVO
12ARRJK

LOCALIZAÇÃO:

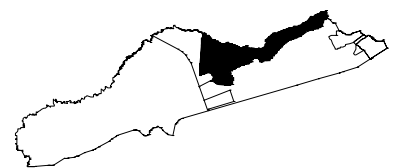

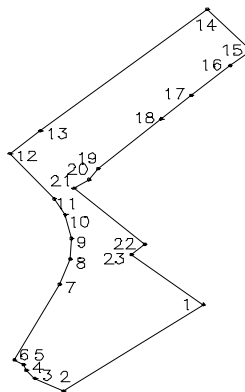

**PLANO DIRETOR LOCAL
SAMAMBAIA - RA XII**

SECRETARIA DE ESTADO DE DESENVOLVIMENTO URBANO E HABITAÇÃO
SUBSECRETARIA DE URBANISMO E PRESERVAÇÃO-SUDUR

SUBCENTRO LESTE – Complexo Boca da Mata

DESCRIÇÃO DOS PERÍMETROS

DESENHO
Ana Carla

DATA:
Mar./2001

ESCALA:
1/25000

ARQUIVO
12CBM

LOCALIZAÇÃO:



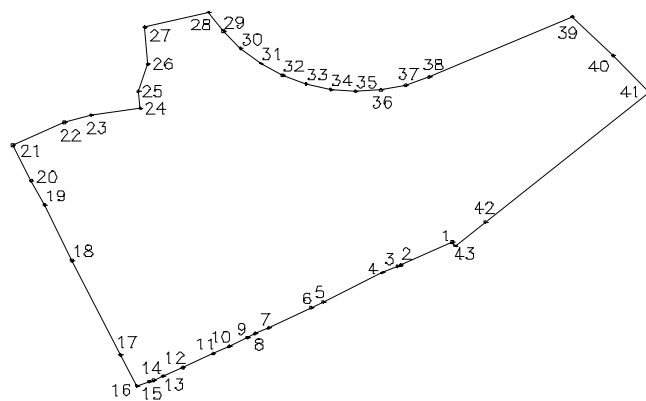

**PLANO DIRETOR LOCAL
SAMAMBAIA - RA XII**

SECRETARIA DE ESTADO DE DESENVOLVIMENTO URBANO E HABITAÇÃO
SUBSECRETARIA DE URBANISMO E PRESERVAÇÃO - SUDUR

SUBCENTRO LESTE – Complexo de Furnas

DESCRIÇÃO DOS PERÍMETROS

DESENHO: Ana Carla	DATA: Mar./2001	ESCALA: 1/25000	ARQUIVO 12CFRNS
-----------------------	--------------------	--------------------	--------------------

LOCALIZAÇÃO



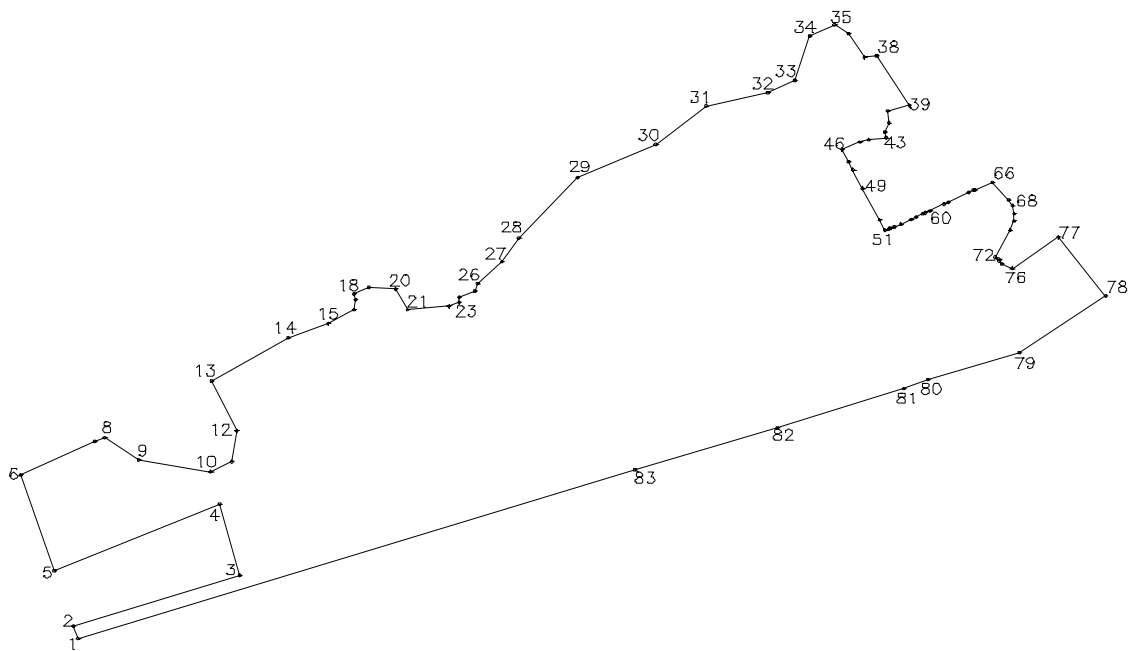

**PLANO DIRETOR LOCAL
SAMAMBAIA - RA XII**

SECRETARIA DE ESTADO DE DESENVOLVIMENTO URBANO E HABITAÇÃO
SUBSECRETARIA DE URBANISMO E PRESERVAÇÃO - SUDUR

MALHA URBANA EXISTENTE

DESCRIÇÃO DOS PERÍMETROS

DESENHO:
Ana Carla

DATA:
Mar./2001

ESCALA:
1/25000

ARQUIVO
12MUEX

LOCALIZAÇÃO:



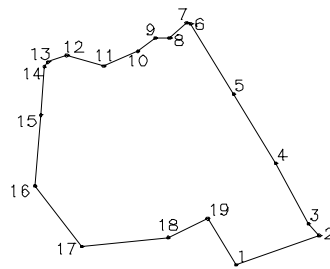

**PLANO DIRETOR LOCAL
SAMAMBAIA - RA XII**

SECRETARIA DE ESTADO DE DESENVOLVIMENTO URBANO E HABITAÇÃO
SUBSECRETARIA DE URBANISMO E PRESERVAÇÃO - SUDUR

ÁREA DE LAZER ECOLÓGICO – PARQUE TRÊS MENINAS

DESCRIÇÃO DOS PERÍMETROS

DESENHO:
Ana Carla

DATA:
Mar./2001

ESCALA:
1/25000

ARQUIVO
12P3M

LOCALIZAÇÃO:

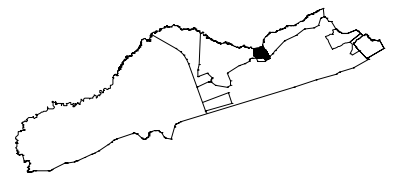

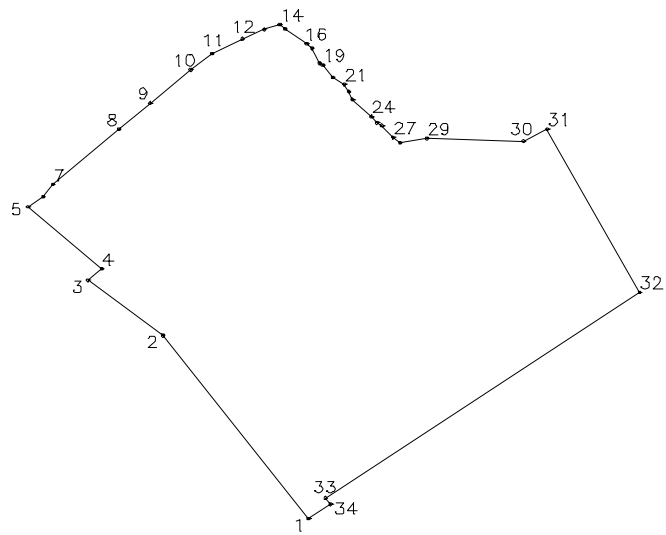

**PLANO DIRETOR LOCAL
SAMAMBAIA - RA XII**

SECRETARIA DE ESTADO DE DESENVOLVIMENTO URBANO E HABITAÇÃO
SUBSECRETARIA DE URBANISMO E PRESERVAÇÃO-SUDUR

ZONA DE CONSERVAÇÃO AMBIENTAL-Parque Boca da Mata

DESCRIÇÃO DOS PERÍMETROS

DESENHO:
Ana Carla

DATA:
Mar./2001

ESCALA:
1/25000

ARQUIVO
12PBM

LOCALIZAÇÃO:

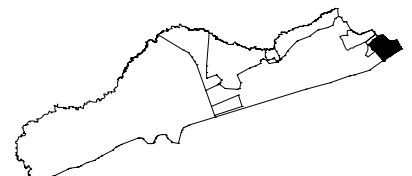

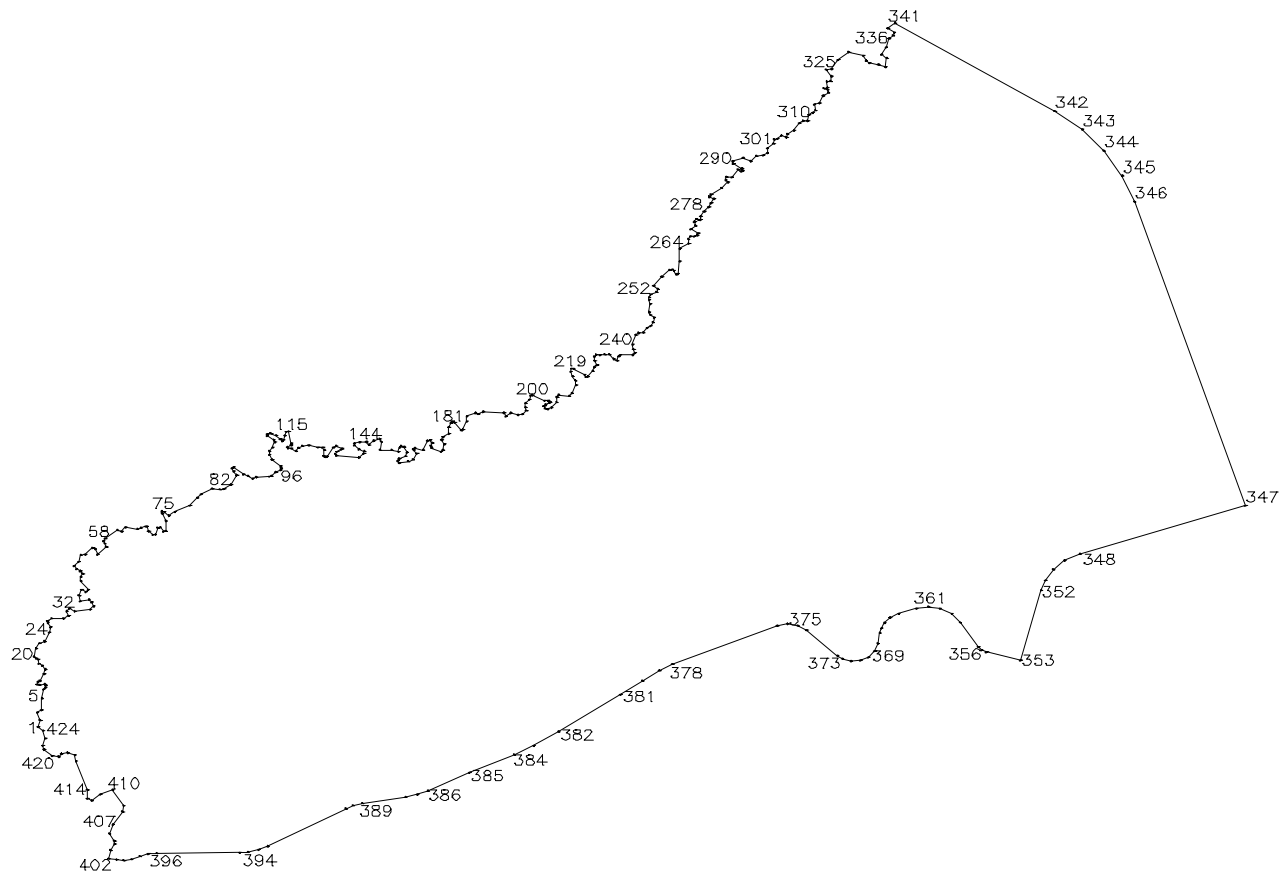

**PLANO DIRETOR LOCAL
SAMAMBAIA - RA XII**

SECRETARIA DE ESTADO DE DESENVOLVIMENTO URBANO E HABITAÇÃO
SUBSECRETARIA DE URBANISMO E PRESERVAÇÃO—SUDUR

ZONA RURAL DE USO DIVERSIFICADO

DESCRIÇÃO DOS PERÍMETROS

DESENHO:
Ana Carla

DATA:
Mar./2001

ESCALA:
1/25000

ARQUIVO
12ZRUD

LOCALIZAÇÃO:

